

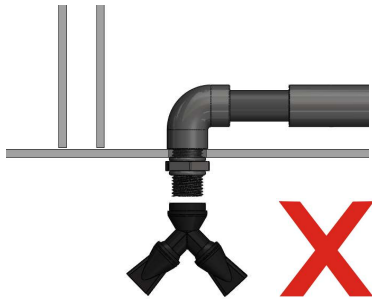

IMPORTANT

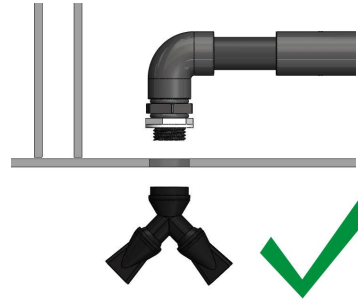

Do NOT screw the nozzle directly to the pre-assembled connector and plumbing!



Strictly follow the instruction below for nozzle installation!

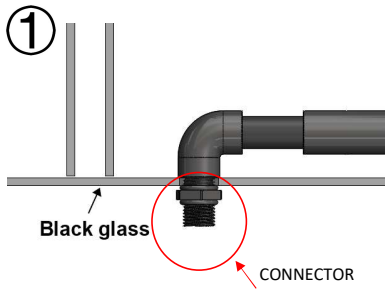

1. Pre-assembled position (connector on display tank side).

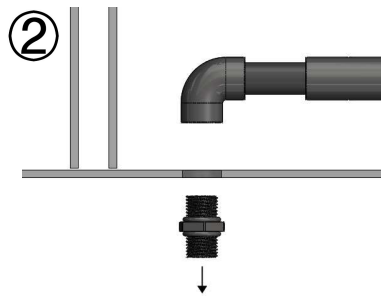

2. Unscrew the connector from black glass.

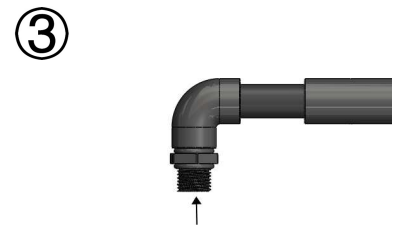

3. Screw the connector to the main outlet pipe.

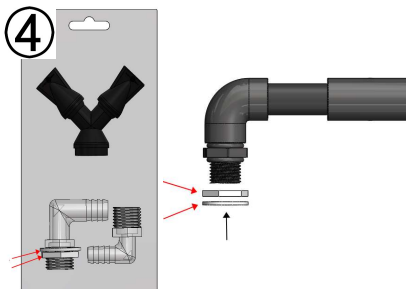

4. Take out the gasket and O-ring from the nozzle kit, and attach them to the connector.

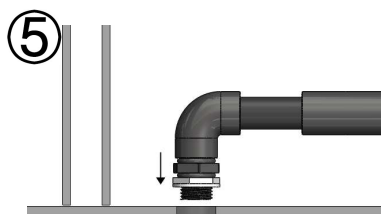

5. Put connector through the hole on black glass. O-ring must be attaching to black glass.

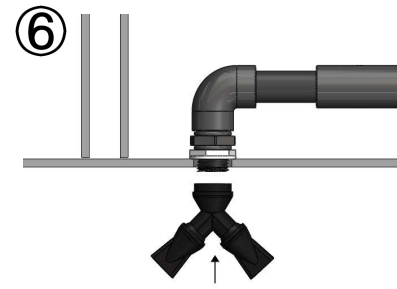

6. Screw on the Y-shape flare nozzle from display tank side.