

Sensibo Pure

Installation Manual

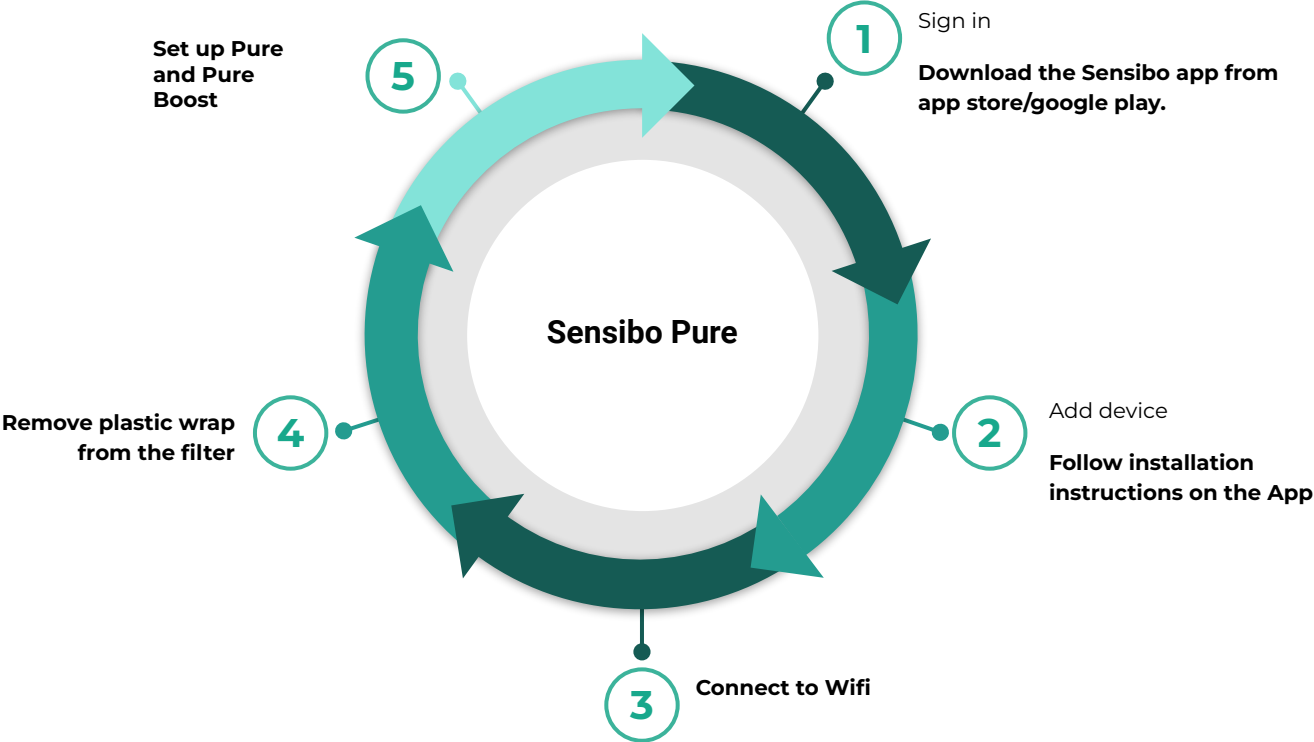

Installation Process Overview



Welcome to Sensibo!

Congrats! You just received your Pure device.

Let's unbox it - In the box in front of you, there should be the device and a power cable.



Downloading the app

01

First, you will need to **download the Sensibo app**, if you haven't done so already.

- Sensibo supports Android & iOS.

Once downloaded, follow the in-app instructions to **create your Sensibo account**.

Sign Up

02

Open the app and
Press on 'Sign up'

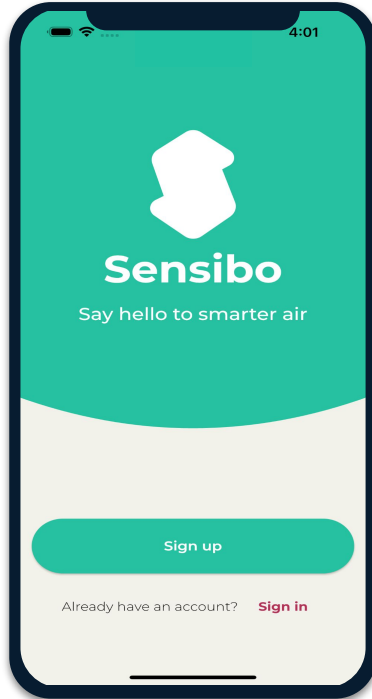

Fill in all the fields

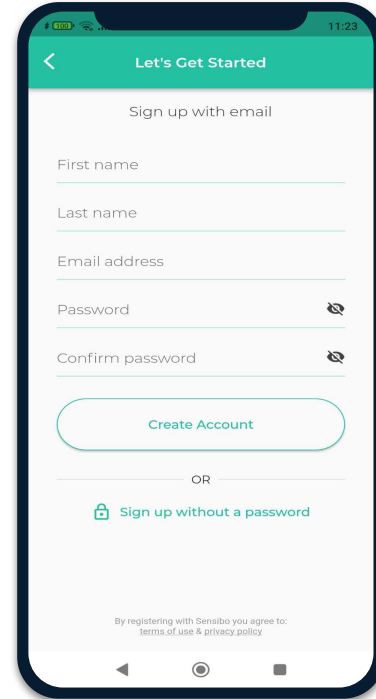

Adding the device

03

Add your Sky device by selecting the three horizontal bars on the top left-hand corner of the app and select "Sensibo Sky"

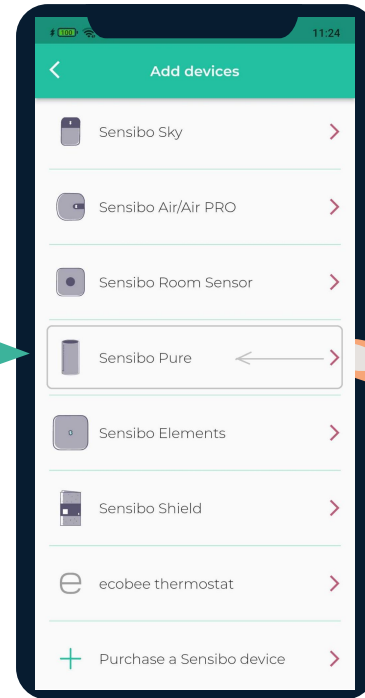
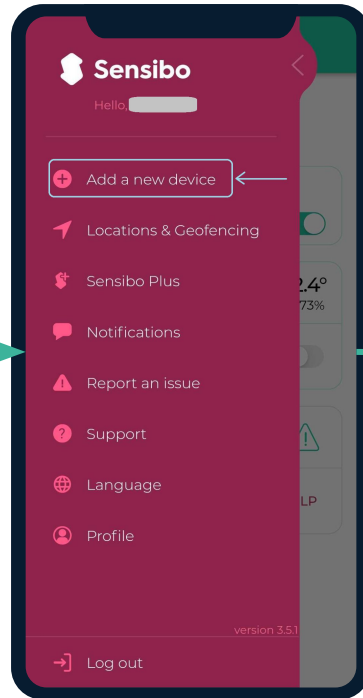
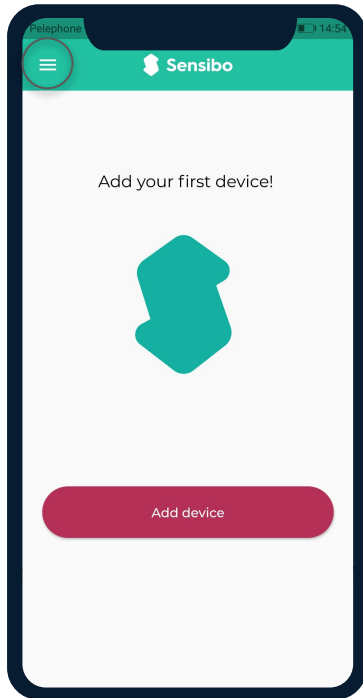

Scanning the device

04

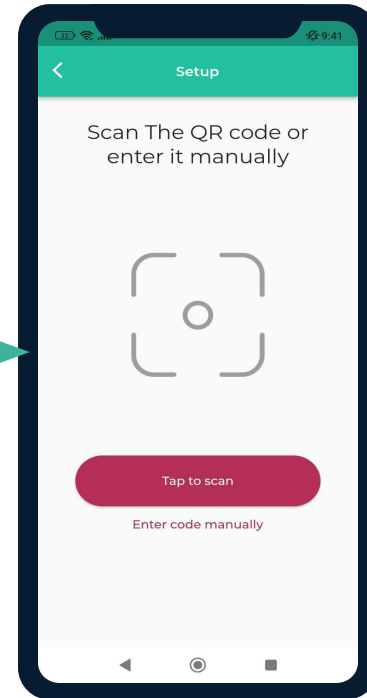
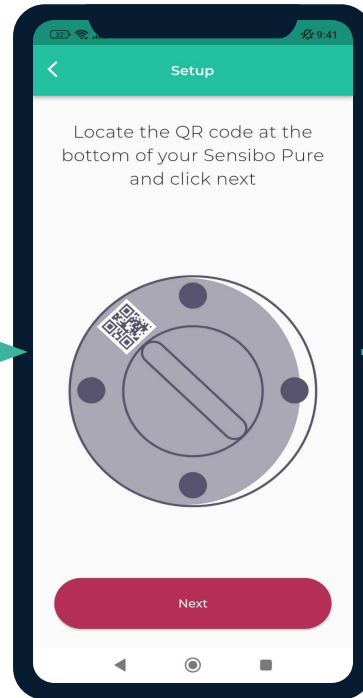
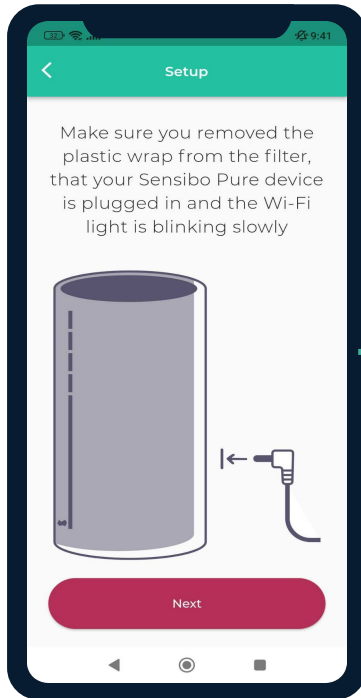

Adding a location

05

Add a new location or choose existing one.

Your first installation will require you to add a location.

Future device installations will allow you to use this location or adding a new one.

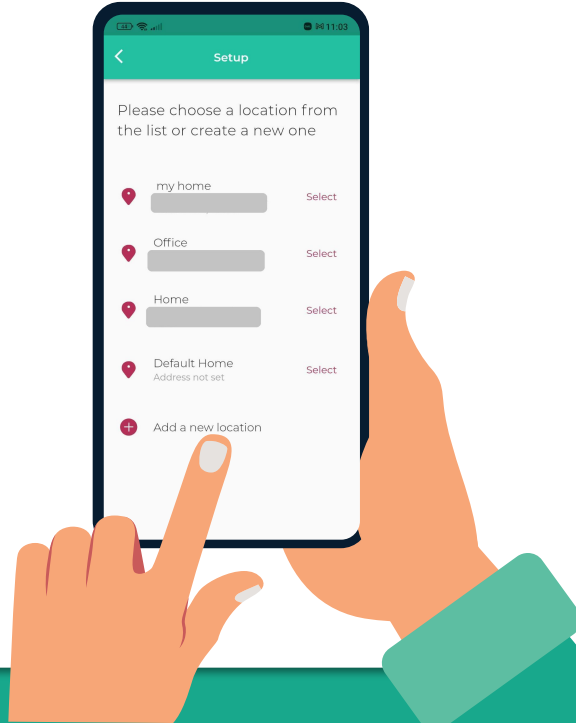

Choosing a room

06

For **each room**, please designate a **new room**.
You can set up the room's name and choose an icon.

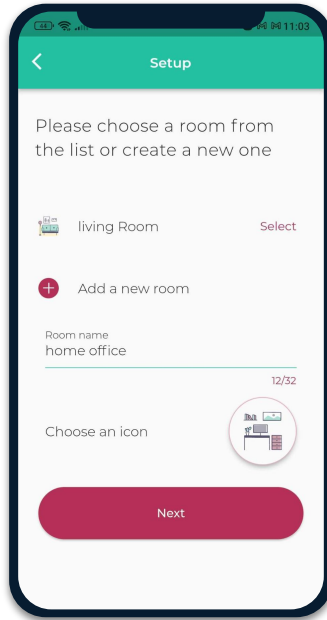

If you select an existing room, you will have 2 devices with the same name.

Connecting your device to WiFi 07

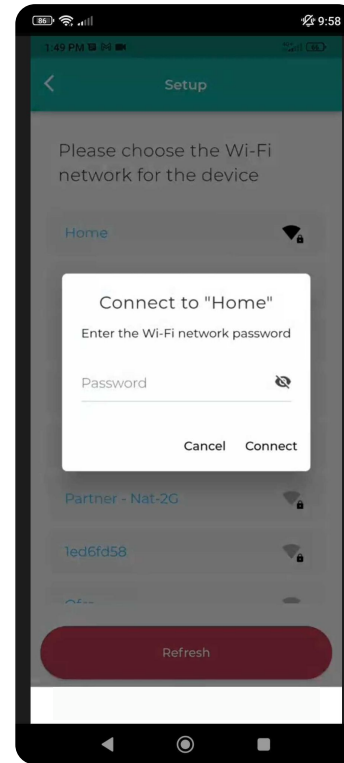
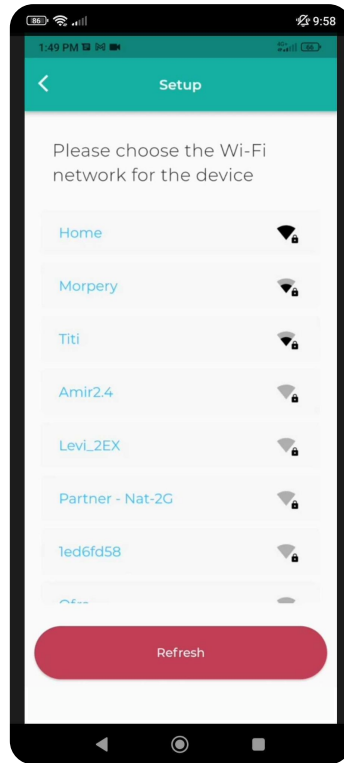
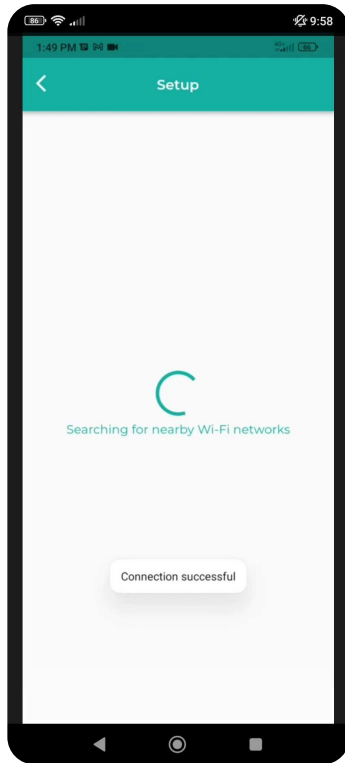

App Introduction

08

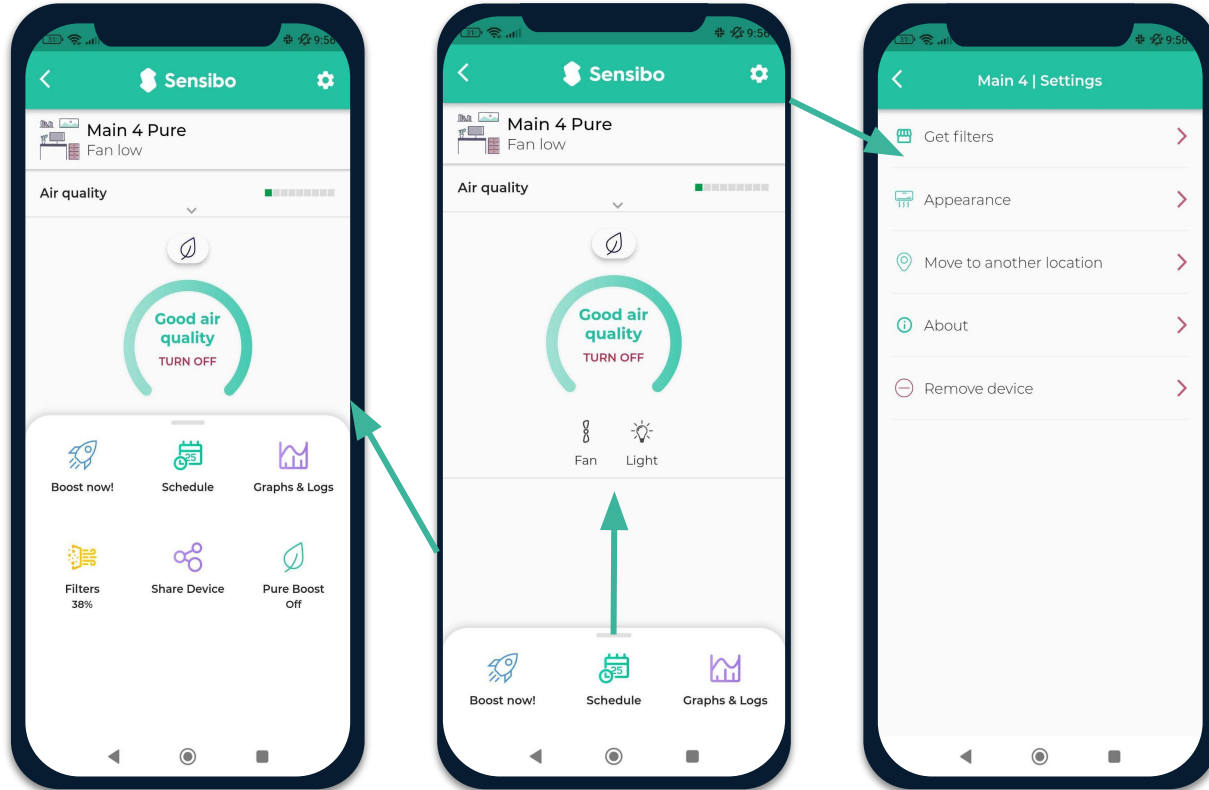

App Introduction

09

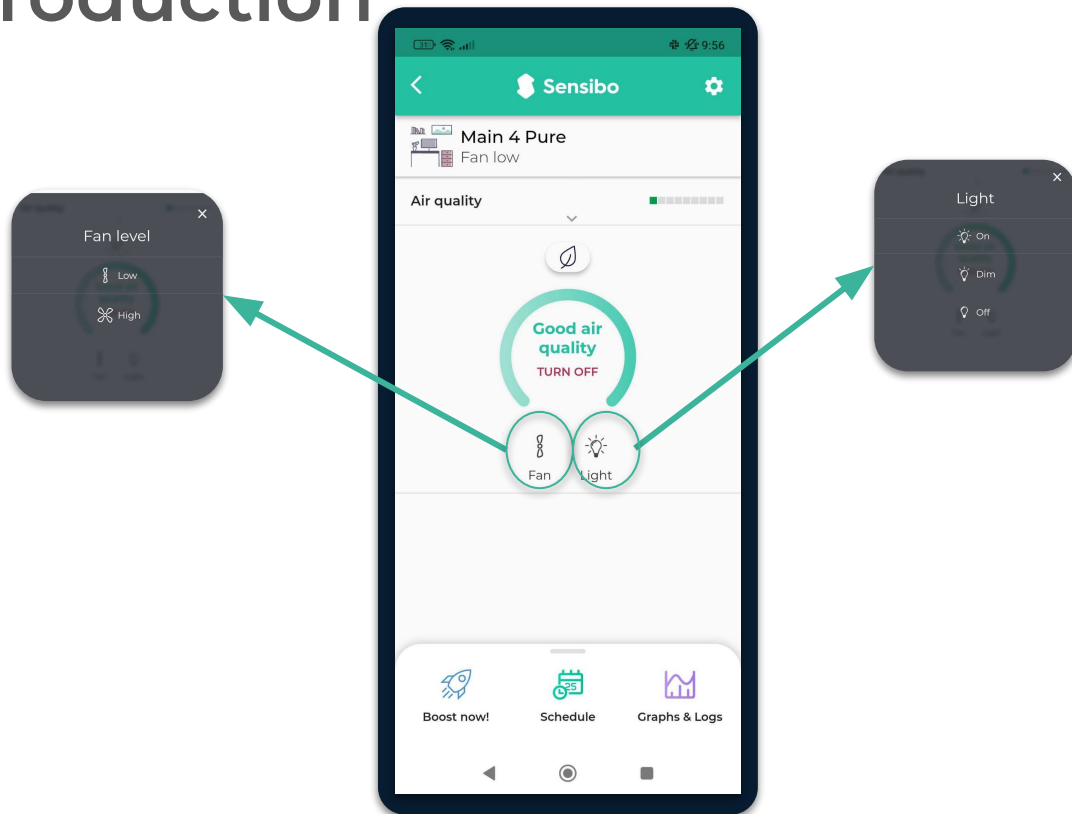

Pure Boost™

You will then be prompted to select your sensitivity to dust and pollution to determine when PureBoost™ will trigger - Normal or Sensitive. Then select when you would like the PureBoost™ to trigger.

- You can boost when indoor or outdoor air quality is poor or both.
- You can also select to boost when away by selecting a geofence radius.
- Have a Sensibo Sky, Air, or Air PRO device? Great! You can also link the Pure to your A/C to use your A/C fan mode to improve air circulation and filtration in your home.

You decide on the trigger that suits you best.

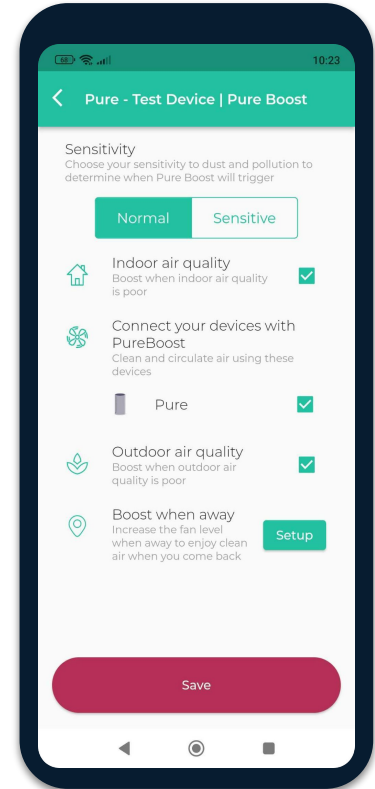

Thank You!

We invite you to email us for any issue, question, or suggestion to
support@sensibo.com