

Sensibo Sky

Installation Manual

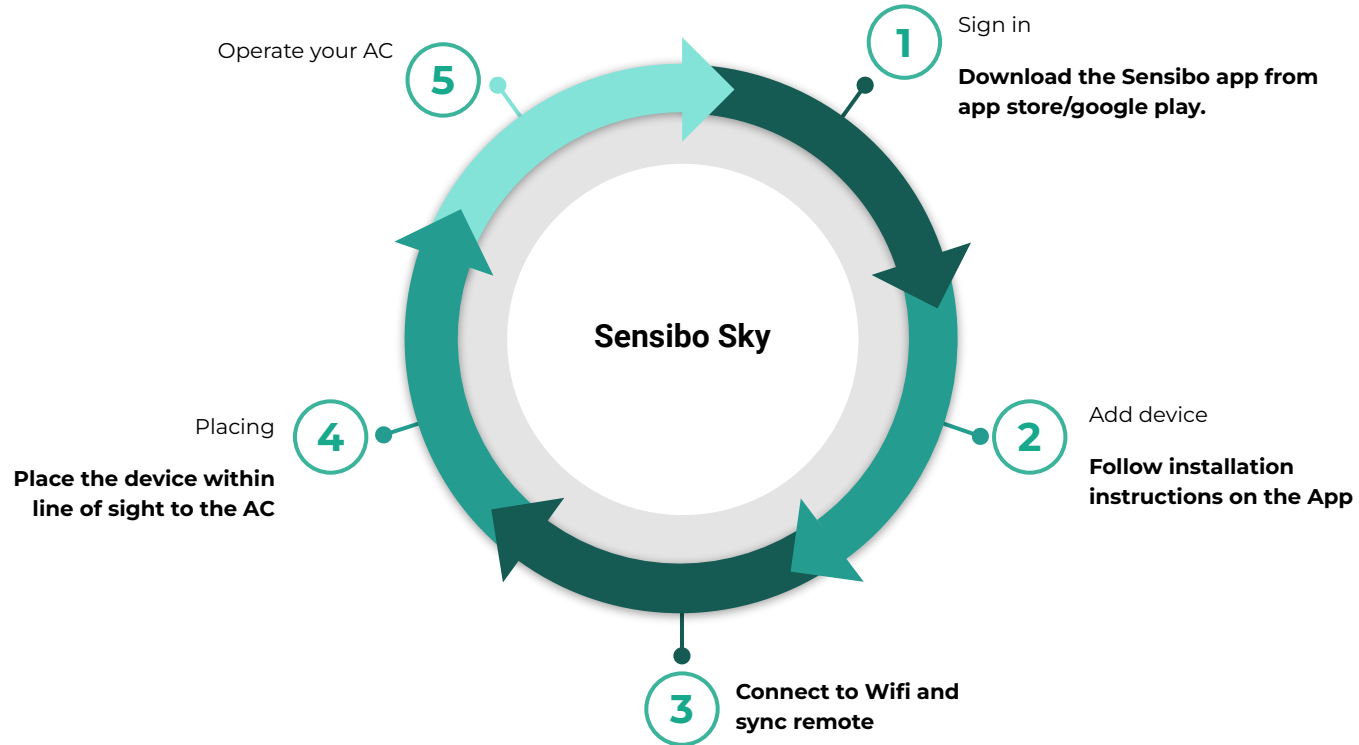

Installation Process Overview



Welcome to Sensibo!

Congrats! You just received your devices.

Let's unbox them - In the box in front of you, there should be the device, a micro USB cable and a power adapter, as shown:

Power plug
according to
shipping address



Sensibo Sky



Micro-USB cable



Downloading the app

01

First, you will need to **download the Sensibo app**, if you haven't done so already.

- Sensibo supports Android & iOS.

Once downloaded, follow the in-app instructions to **create your Sensibo account**.

Sign Up

02

Open the app and
Press on 'Sign up'

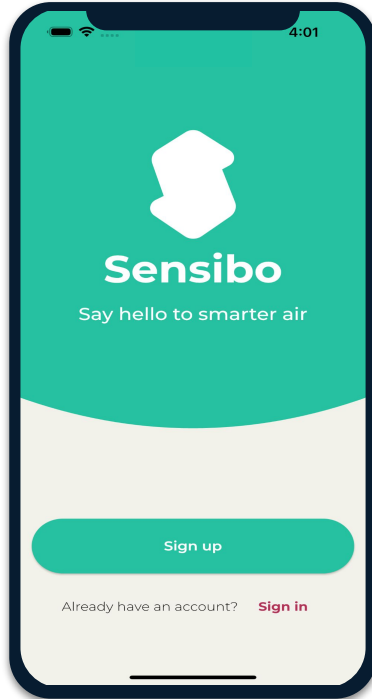

Fill in all the fields

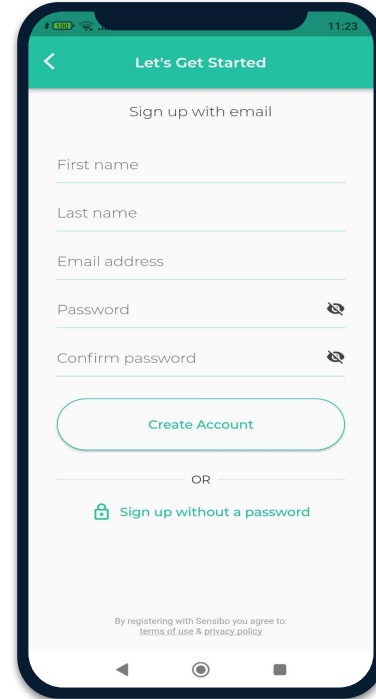

Adding the device

03

Add your Sky device by selecting the three horizontal bars on the top left-hand corner of the app and select "Sensibo Sky"

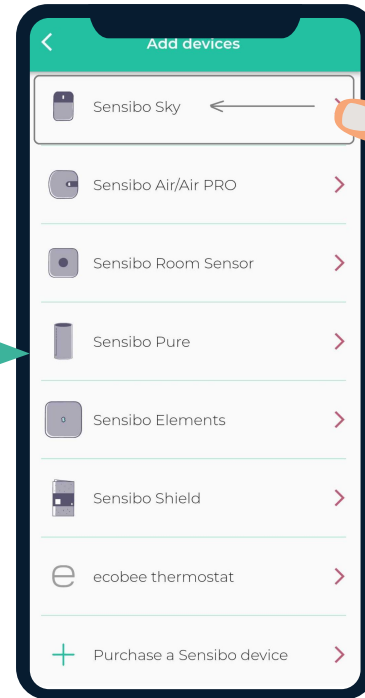
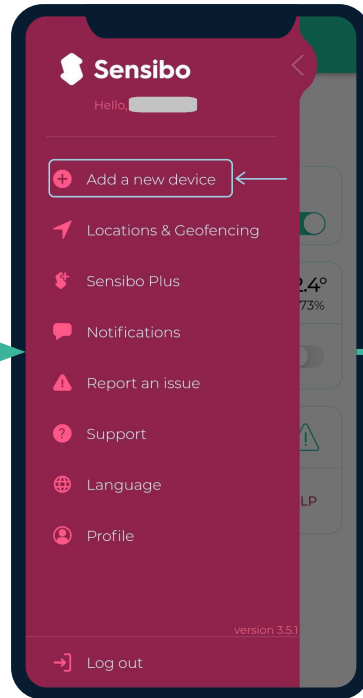
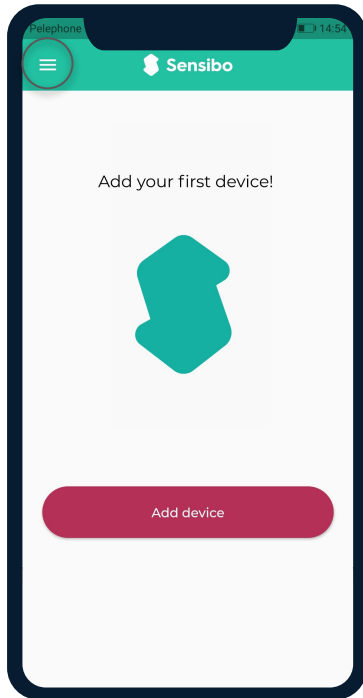

Scanning the device

04

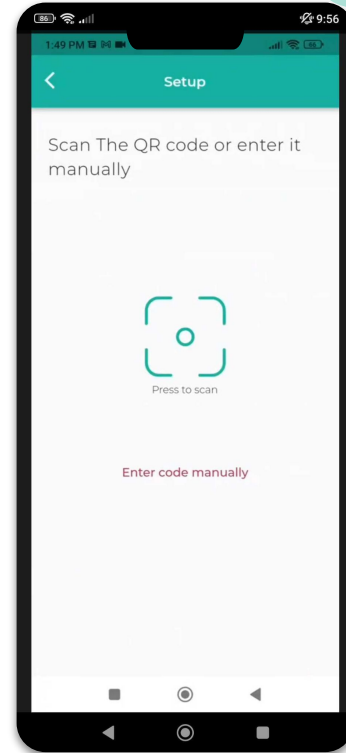
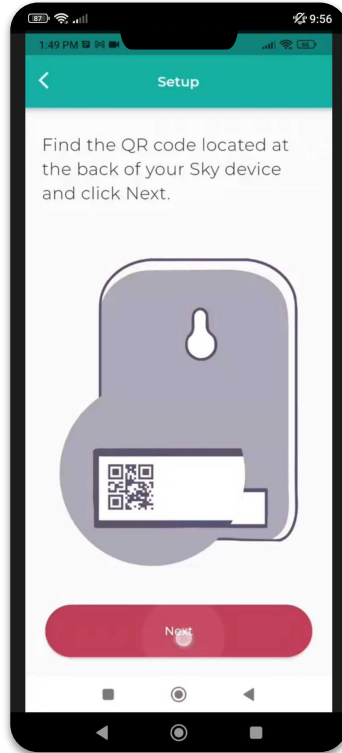

Adding a location

05

Add a new location or choose existing one.

Your first installation will require you to add a location.

Future device installations will allow you to use this location or adding a new one.

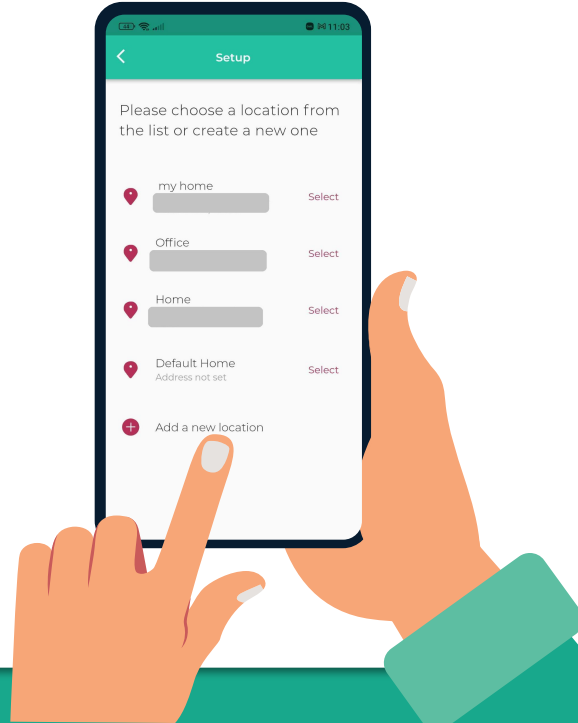

Choosing a room

06

For **each room**, please designate a **new room**.
You can set up the room's name and choose an icon.

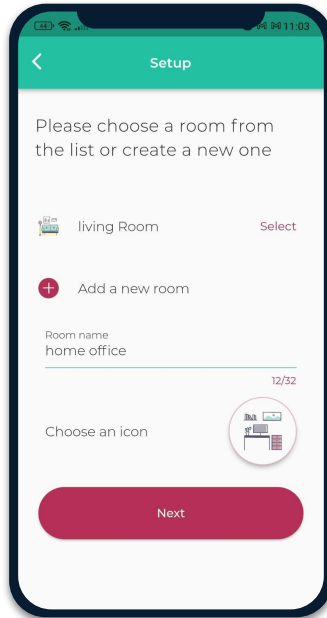

If you select an existing room, you will have 2 devices with the same name.

Connecting your device to WiFi 07

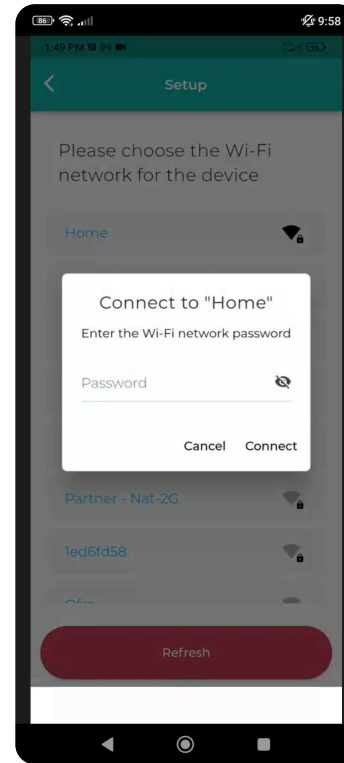
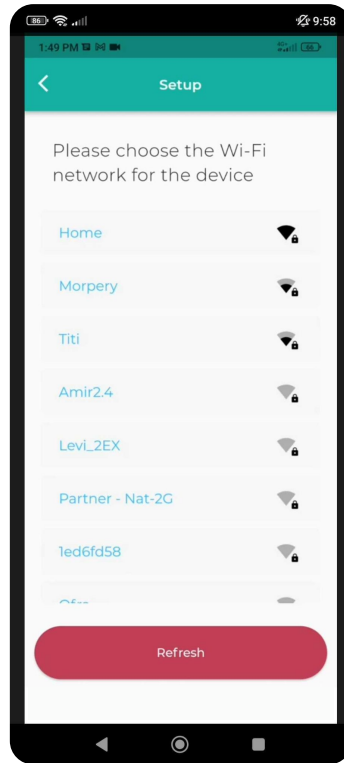
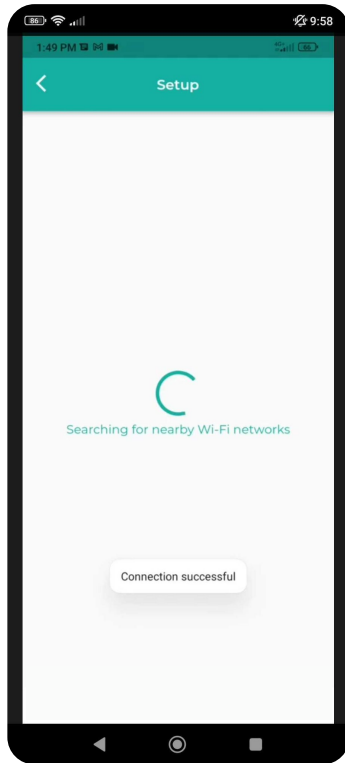

Syncing Your AC Remote

08

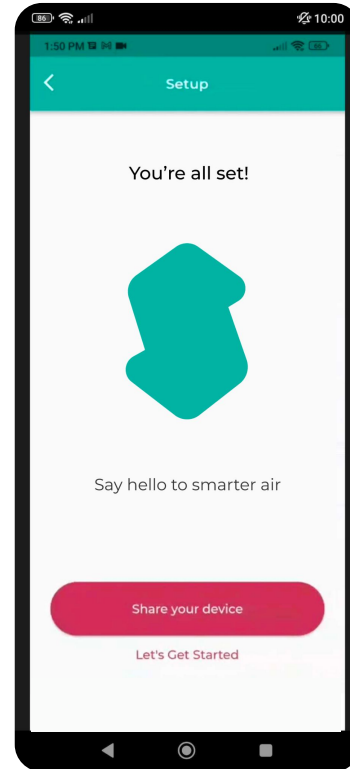
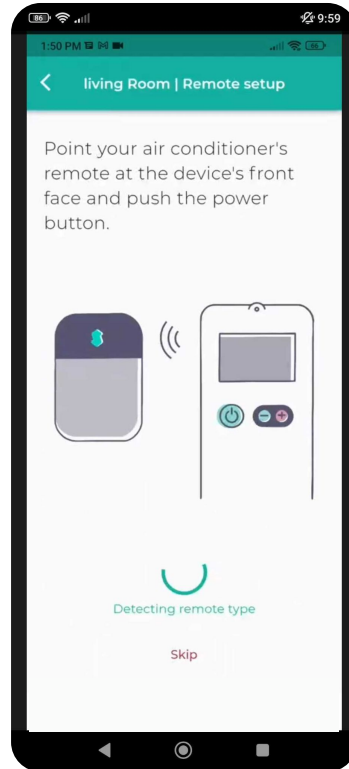
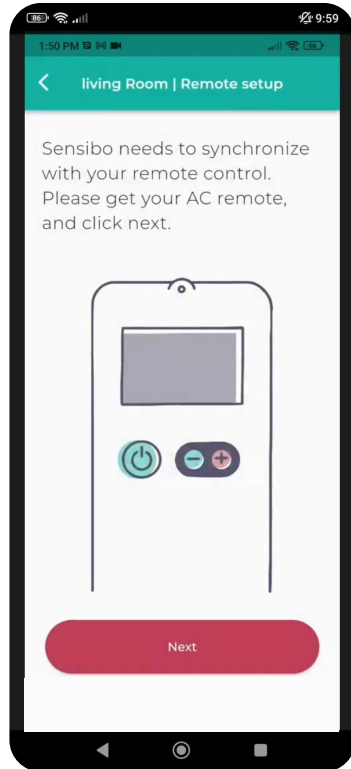

WiFi Manual Connection

09

Please try the following steps in order to **manually connect the device to your Wi-Fi network**:

1. Connect the Sensibo Sky to power outlet.
2. While the Sensibo device is connected to power, reset it by inserting a paperclip into the little hole on the side of the device.

The device should blink once every few seconds.

**If it does not, please reset the device by pressing the reset button again (repeatedly if necessary) until it blinks once every few seconds.*

3. On your computer/phone open your Wi-Fi setting and connect to the SENSIBO-I-XXXXX network. The network does not have internet access so continue without internet access for the duration of the setup.
4. Open a browser window and enter the address <http://192.168.1.1>
5. Click 'Configure Wi-Fi'
6. Enter your Network name and password
**Please note that it is case-sensitive.*
7. Click "Save"
8. The device should start blinking. Once it stops you are connected..

Installation Examples

10

We recommend placing the Sensibo up to five meters away from the air conditioner. Placing the device as close as possible to the AC, will ensure the strongest connection.

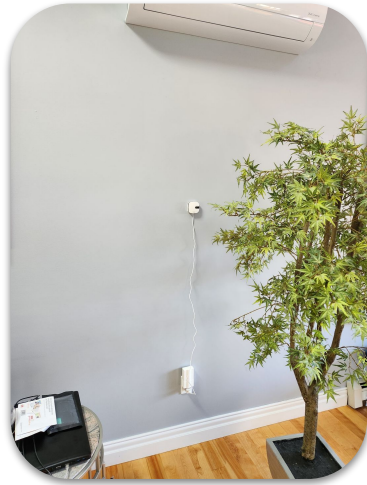

What if I have 2 AC Units in One Room? **11**

If you have **2 air conditioners of the same make & model**, and if they have the **same remote** - one sensibo device can operate them simultaneously.



If the **air conditioners are different**, you will need **2 separate sensibo devices**. Each device will operate the AC that it is located within its line of sight.



App Introduction

12

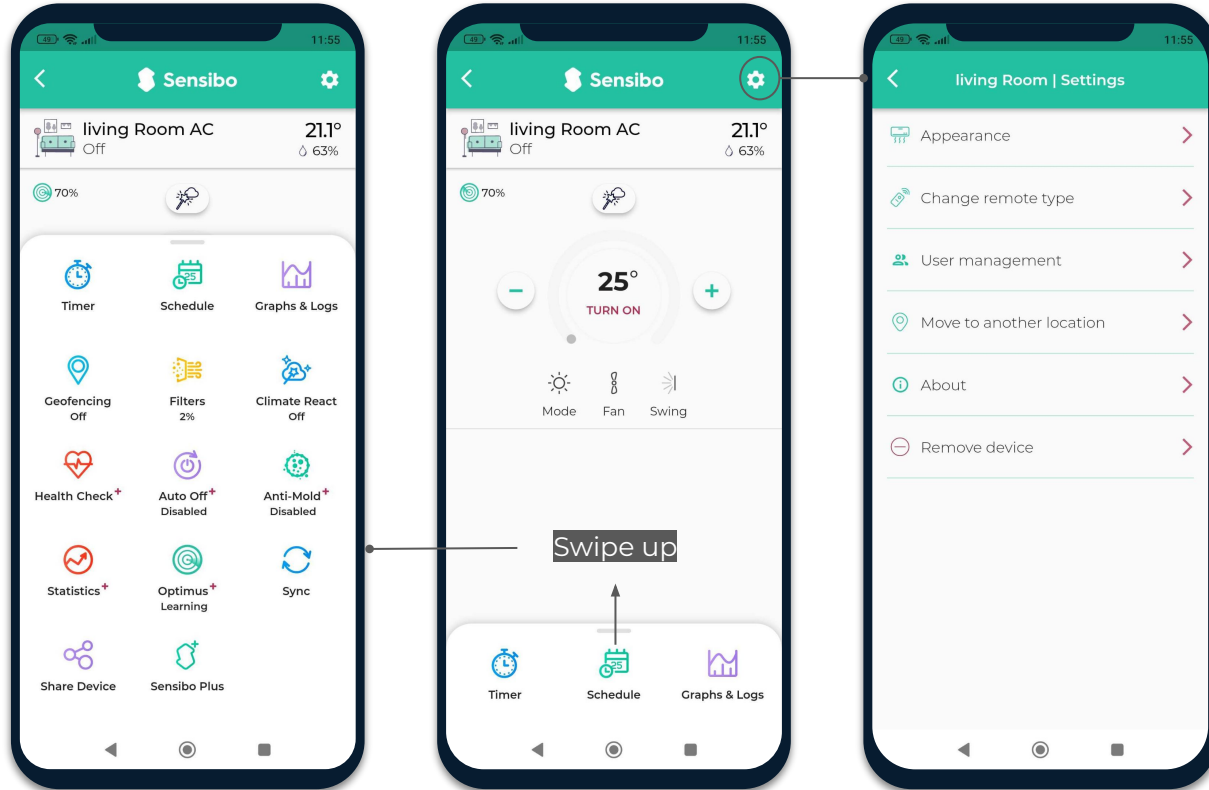

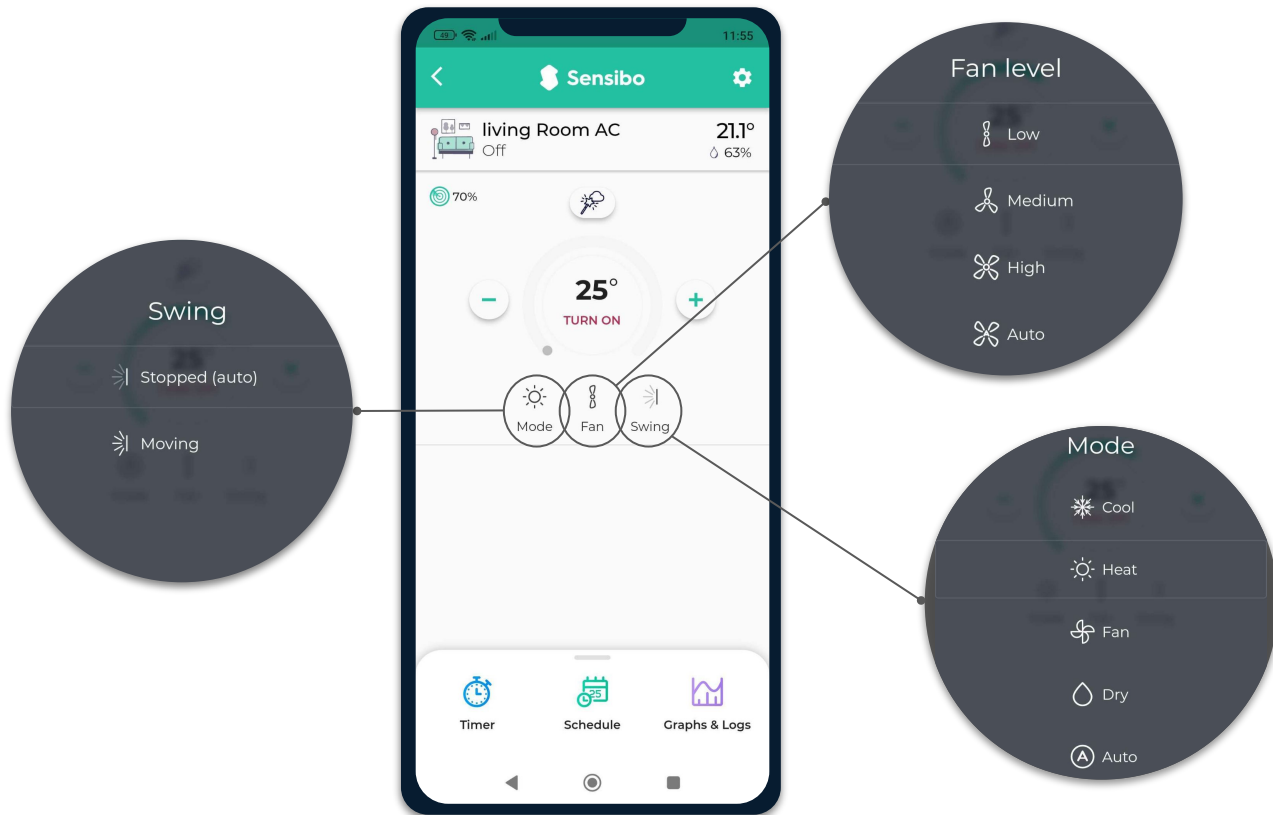

Sensibo Plus Features

13

- Detect AC efficiency issues with “AC Health Check”. Run your AC through a battery of tests and determine if it is cooling efficiently based on years of aggregated air conditioner data.
- Get live weather and outdoor air quality updates. Our AI powered algorithm uses local temperature, humidity and air quality to suggest optimized AC settings.
- Enjoy weekly and monthly usage graphs and view historical temperature, humidity and user activity data
- Using machine learning, Sensibo Plus can detect anomalies such as open windows or humid weather and suggest the most energy efficient temperature to set your air conditioner
- Take your air conditioning automation to the next level. Now you can combine [Climate React](#) with [Schedule](#) and [Geofencing](#), ensuring the perfect climate. “parameters”
- Protect the air you breathe with our Anti-Mold feature, designed to dry residual moisture in your AC to reduce mold growth.

Thank You!

We invite you to email us for any issue, question, or suggestion to
support@sensibo.com