

MANGATA ORION POWERBANK USER MANUAL



MANGATA
CASES

POWER YOUR
Moments

Power Station Layout

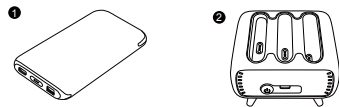

- 1 Power Bank: Output: 5V/2.1A Type-C Input: 5V/2A
- 2 Docking Station: Output: 5V/1.5Ax3 Type-C Input: 5V/3A

Compatible devices

- Most smartphones & tablets
- Smartwatches & fitness trackers
- Digital cameras
- Portable Bluetooth devices such as headsets & speakers
- Portable hand-held gaming consoles

Features

- Capacity: 8000mAh*3pcs 3.7V
- Battery type: Polymer battery
- Rechargeable more than 300 times
- Includes docking station for charging and re-charging
- Built-in overcharging and short circuit protection
- Dock type-c input: DC 5V/3A(MAX)
- Dock output: DC 5V/1.5Ax3
- Power bank type-c input: DC 5V/2A(MAX)
- Power bank output: DC 5V/2.1A(MAX)
- Charging time: about 6-7 hours
- Docking station size: 107x87x69.5mm
- Power bank unit size: 137x70x13mm

How to power the docking station

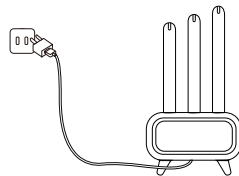

- Connect the USB-C cable that was included in the box to the docking station. Then connect the cable to a power source i.e.
 - USB outlet
 - Wall plug outlet (USB plug not included)

How to charge the power bank

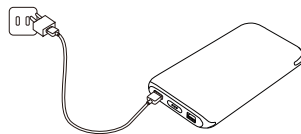

- Simply place the power bank into the charging dock. To charge without the dock, Connect the USB-C cable that was included in the box to the power bank. Then connect the cable to a power source i.e.
 - USB outlet
 - Wall plug outlet (USB plug not included)

How to charge phone or other devices

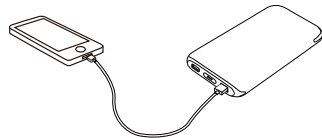

- Connect your phone or other USB devices with suitable cable.
- When your phone or device is fully charged, the power bank will automatically turn itself off.

Important safety instructions

- To maximize battery life span, fully charge power bank for 3 hours before first use.
- Store the power bank in a cool and dry place.
- Do not store the power bank in hot or humid environments.
- Operating temperature should be between -1 to 45°C.
- Charge and discharge at least once every three months.
- In normal conditions, the battery performance will decline slightly over several years.
- Do not dispose of power bank in heat or fire.
- Do not clean power bank with harmful chemicals or detergents.
- Misuse, dropping or excessive force may damage product.



How to turn on display

- Click the button to display the time and temperature on the screen.
- Click the button a second time to turn off the display

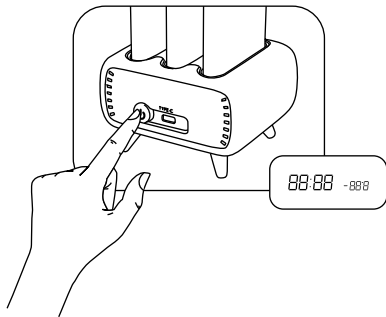

How to setup clock & temperature

- Long press the button for 3 seconds. The hour display will flash. Click the button again to adjust the hour.
- Long press the button for 3 seconds. The minute display will flash. Click the button again to adjust the minutes.
- Long press the button for 3 seconds. The temperature will flash. Click the button again to switch between Celsius and Fahrenheit

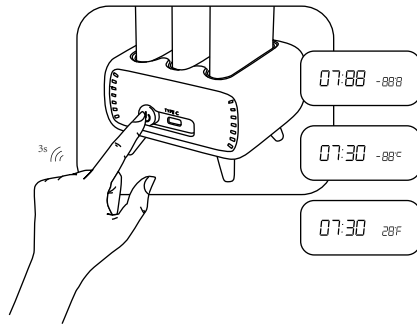

How to exit setup mode

- To exit setup, long press the button for 3 seconds.
- If no button is pressed for 10 seconds, setup mode will exit automatically.

