

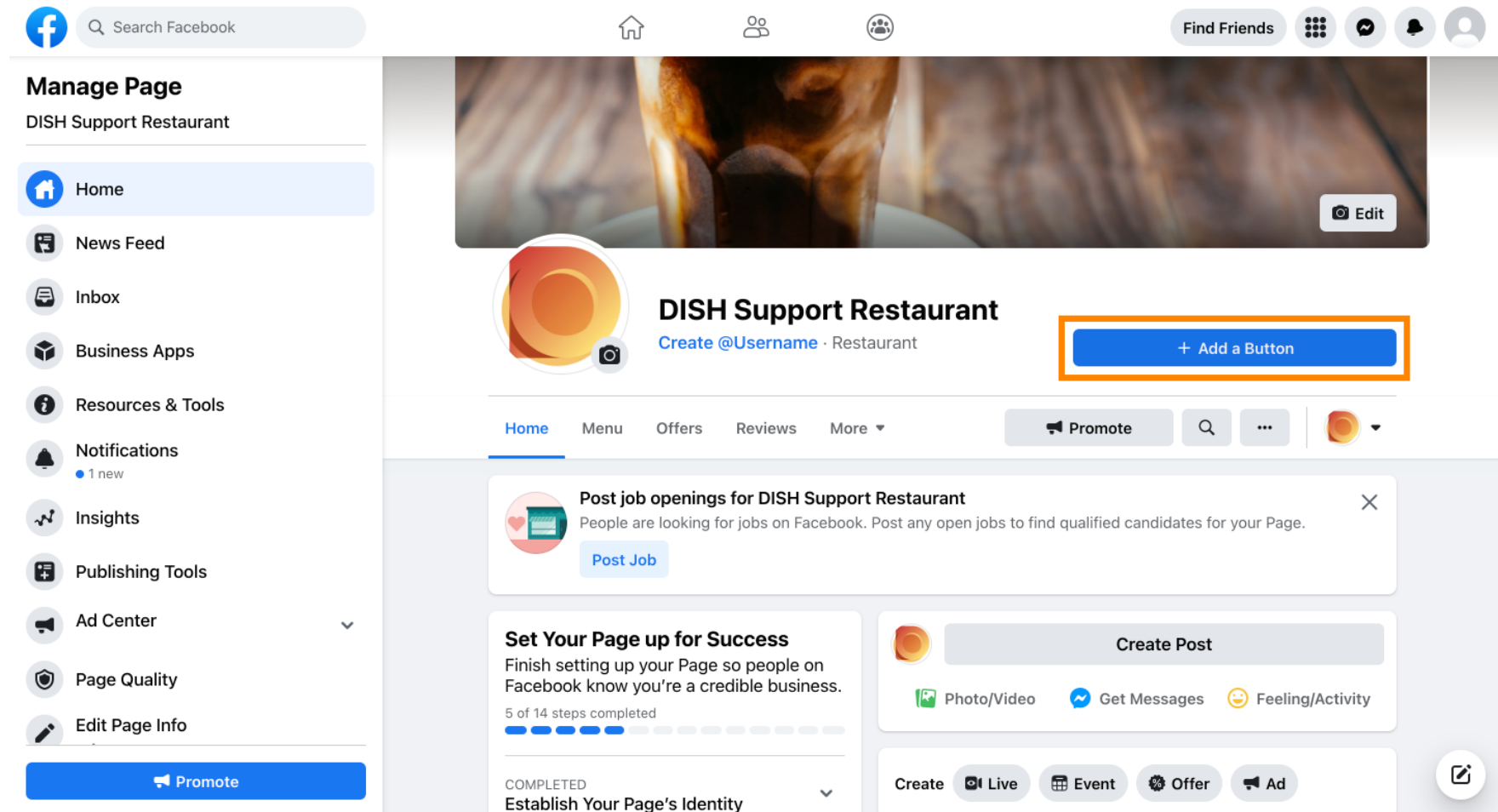

Una volta effettuato l'accesso alla tua pagina Facebook, fai clic su **aggiungi un pulsante**.



The screenshot displays the Facebook Business Page interface for 'DISH Support Restaurant'. On the left, the 'Manage Page' sidebar lists various tools for page management. The main header area shows the page's profile picture, name, and a blue button labeled '+ Add a Button', which is highlighted with an orange rectangle. Below the header, there's a navigation bar with tabs for Home, Menu, Offers, Reviews, and More. The main content area features a notification about posting job openings, a progress bar for setting up the page, and a 'Create Post' section with options for Photo/Video, Get Messages, and Feeling/Activity.



Si aprirà un pop-up con diverse opzioni. Quindi selezionare **l'ordine di inizio**.

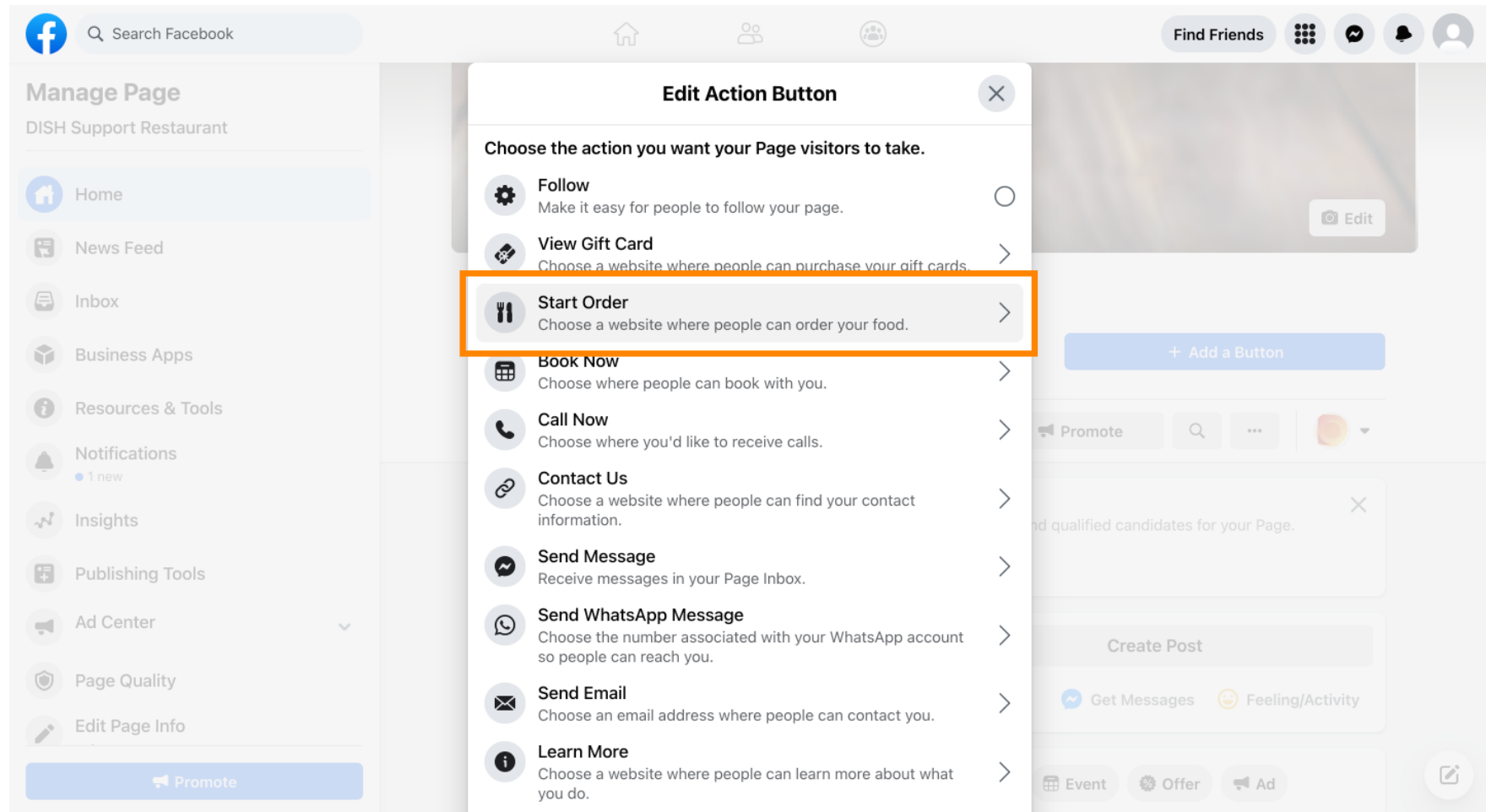



Ora inserisci l' **URL** del menu DISH Order .

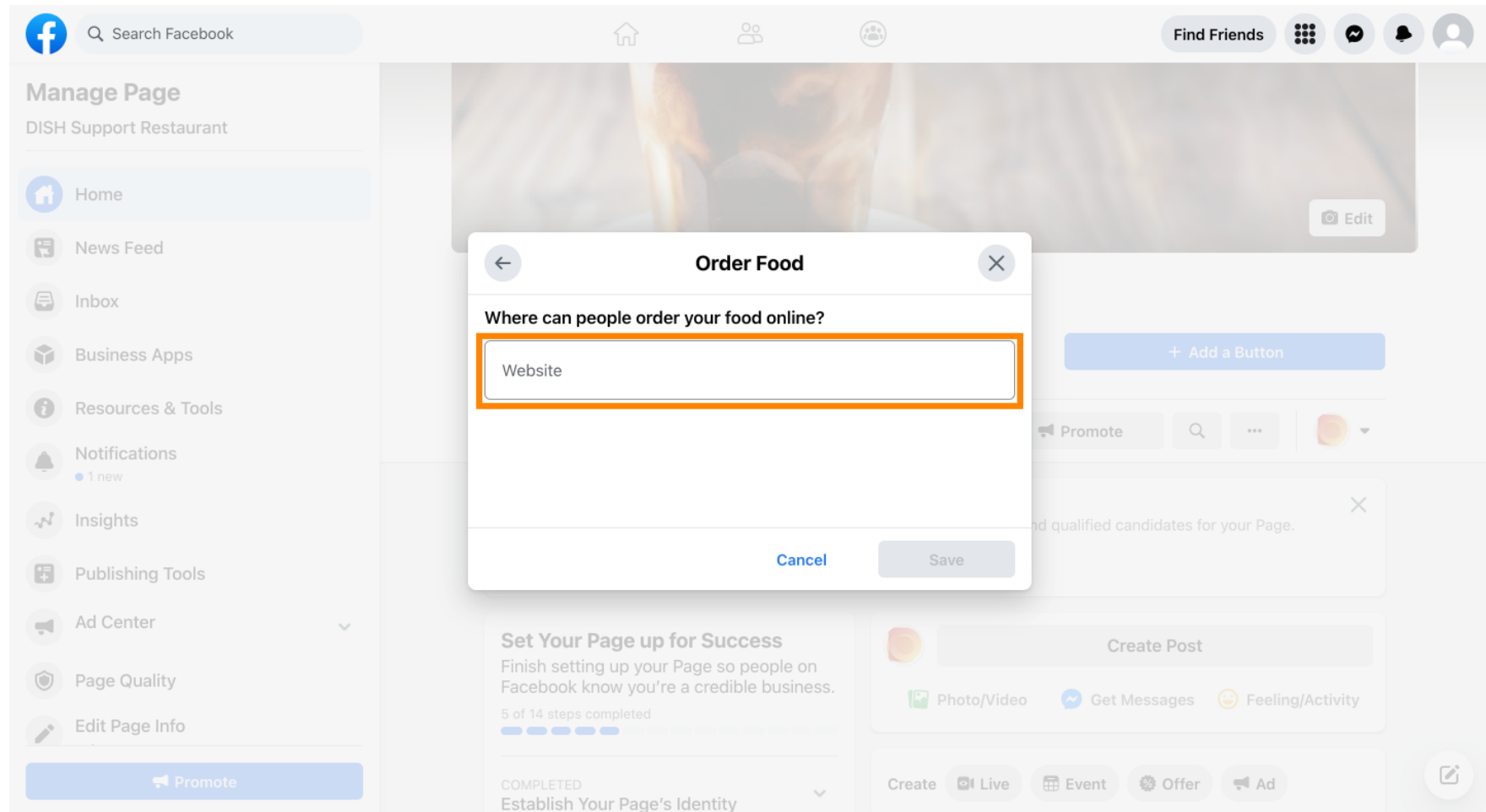



E clicca su **Salva** per procedere.

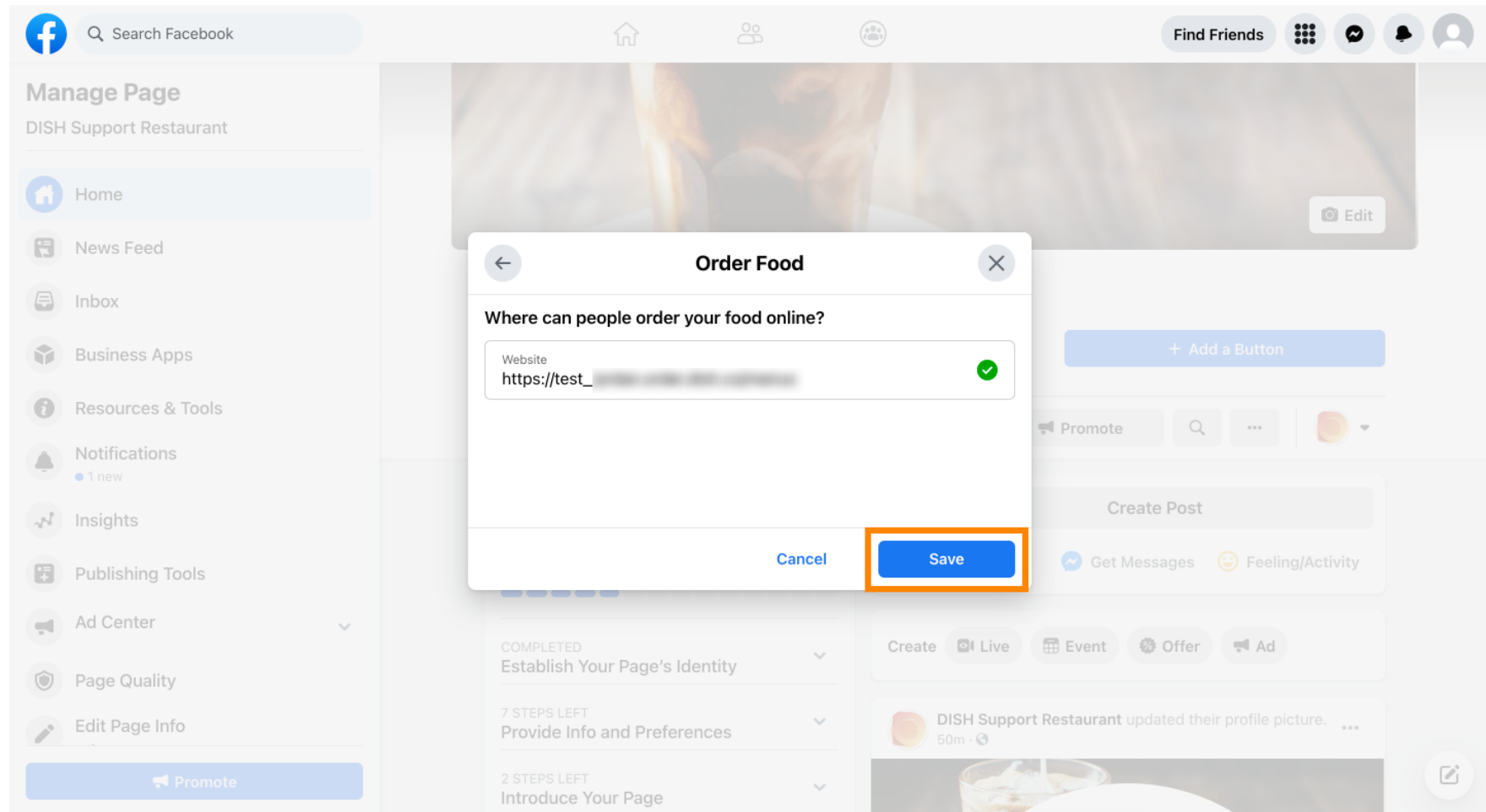



Il piccolo **pop-up** nell'angolo in basso a sinistra indica che il pulsante è stato aggiunto correttamente.

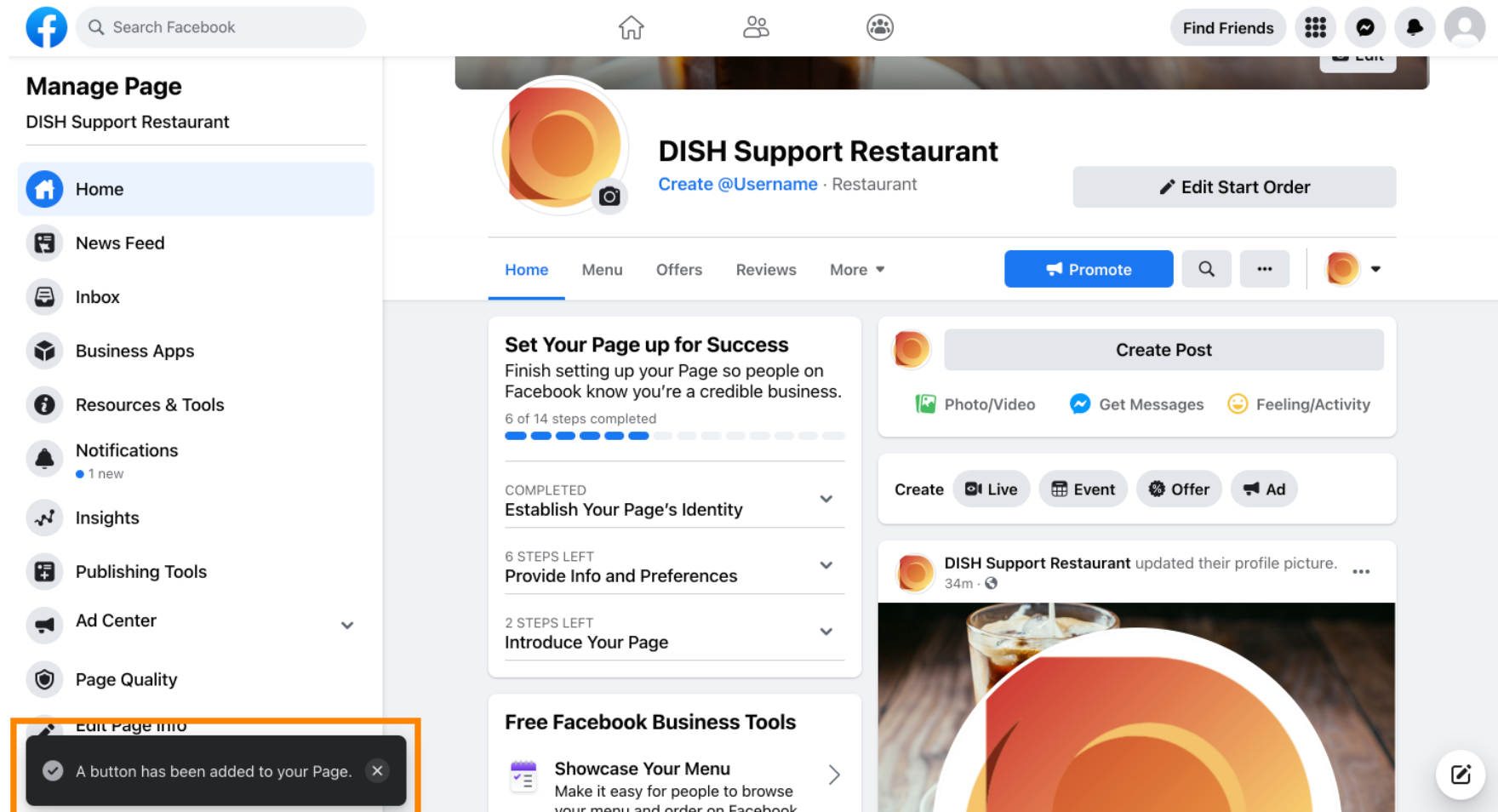

The screenshot shows the Facebook interface for the 'DISH Support Restaurant' page. On the left, the 'Manage Page' sidebar is visible, with the 'Edit Page Info' option highlighted at the bottom. A confirmation pop-up is displayed in the bottom-left corner, stating: 'A button has been added to your Page.' The main content area shows the restaurant's profile, including the cover photo, profile picture, and a 'Set Your Page up for Success' section with progress bars for various setup steps. The right sidebar features a 'Create Post' button and a recent post from the restaurant.



Ecco come sarà per i tuoi ospiti.

