

Once you are logged in to your Facebook page click on **add a button**.

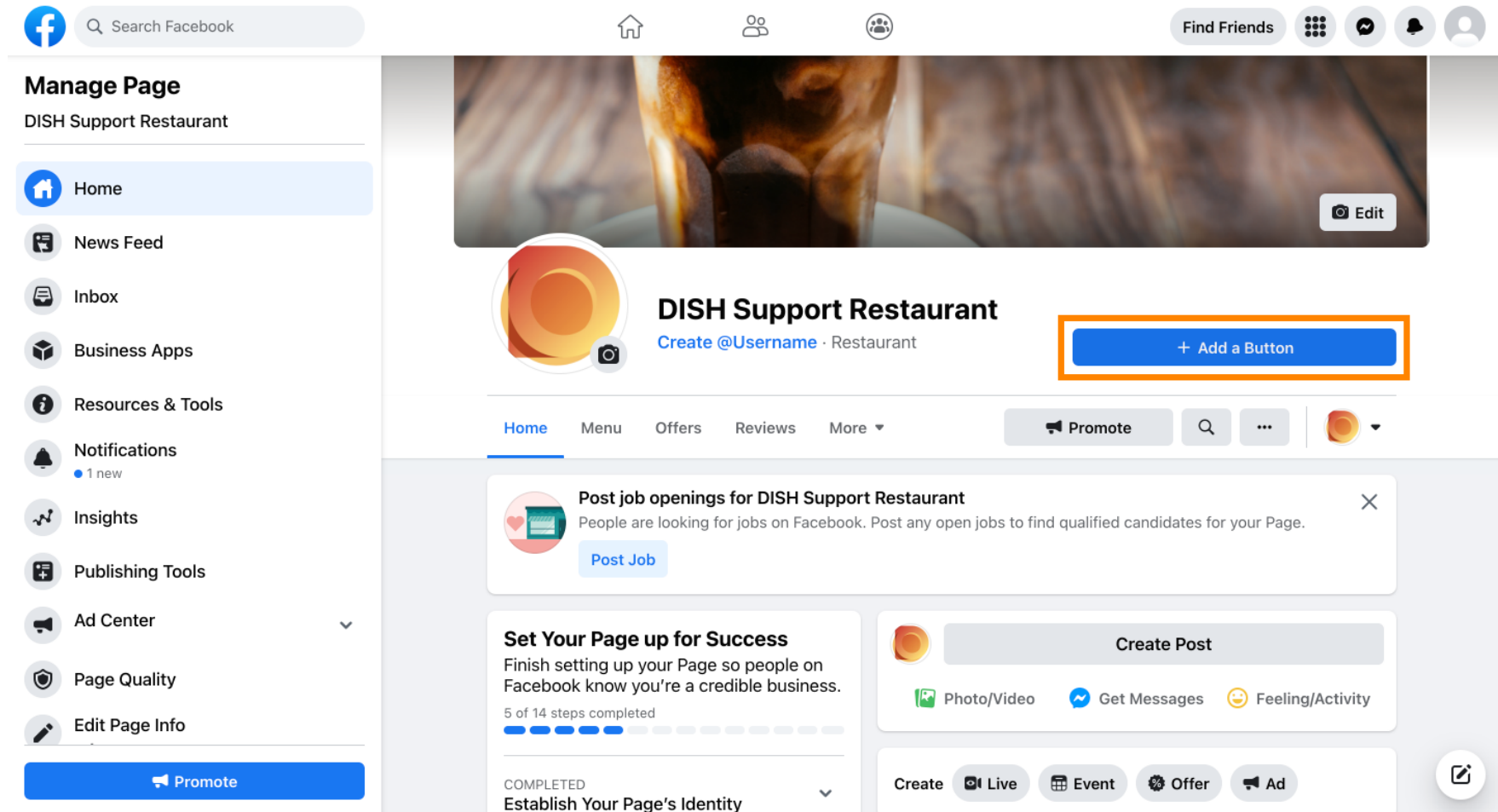

The screenshot shows the Facebook page management interface for 'DISH Support Restaurant'. On the left is a 'Manage Page' sidebar with various tools. The main content area features a cover photo, a profile picture, and a blue '+ Add a Button' button highlighted with an orange border. Below the button are navigation tabs (Home, Menu, Offers, Reviews, More), a 'Promote' button, and a search icon. A notification banner for job openings is visible, followed by a 'Set Your Page up for Success' progress indicator and a 'Create Post' section with options for Photo/Video, Get Messages, and Feeling/Activity. At the bottom, there are buttons for 'Live', 'Event', 'Offer', and 'Ad'.

A pop-up will open with different options. Then select **start order**.

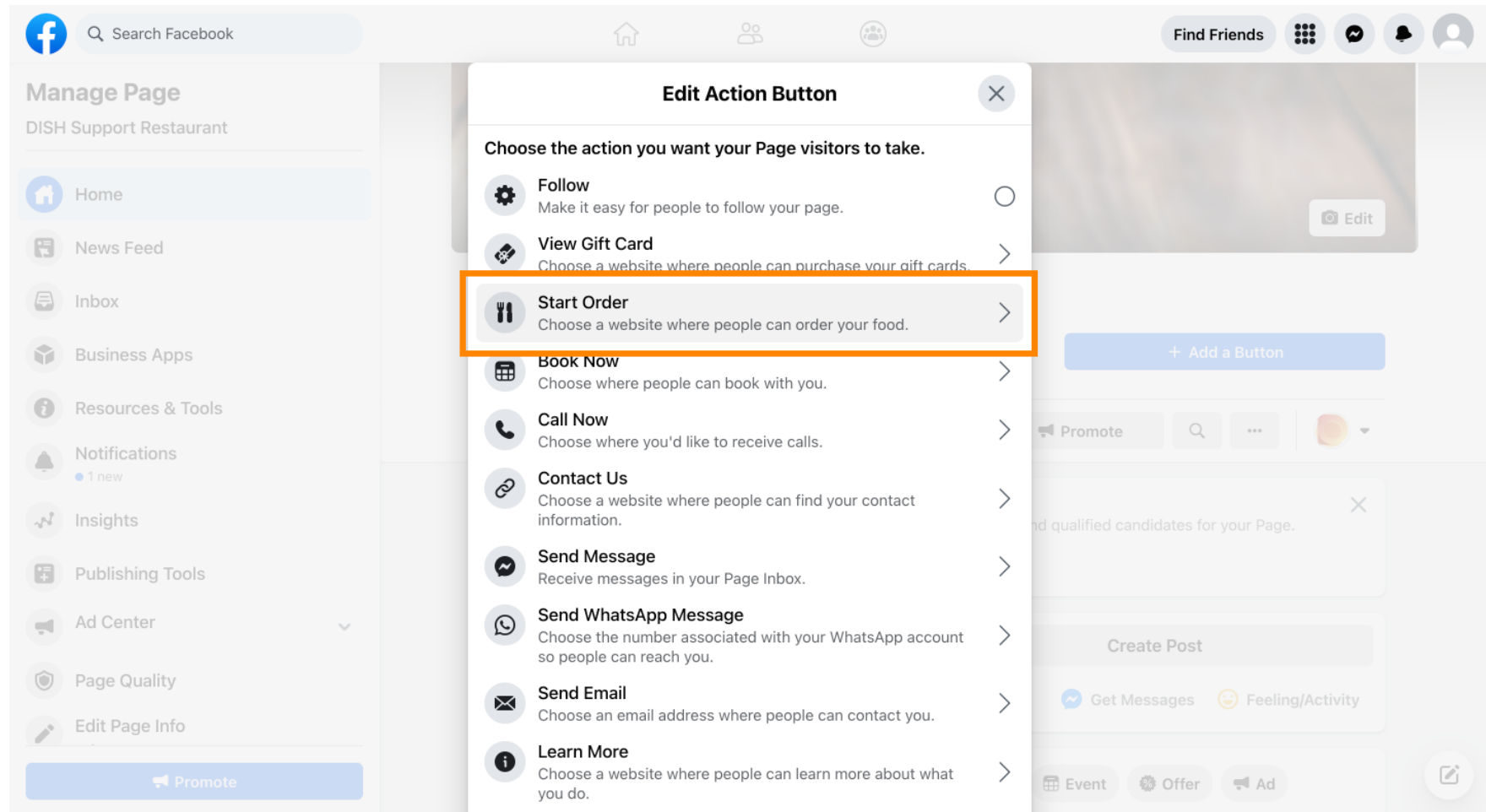



Now enter your DISH Order menu **URL**.

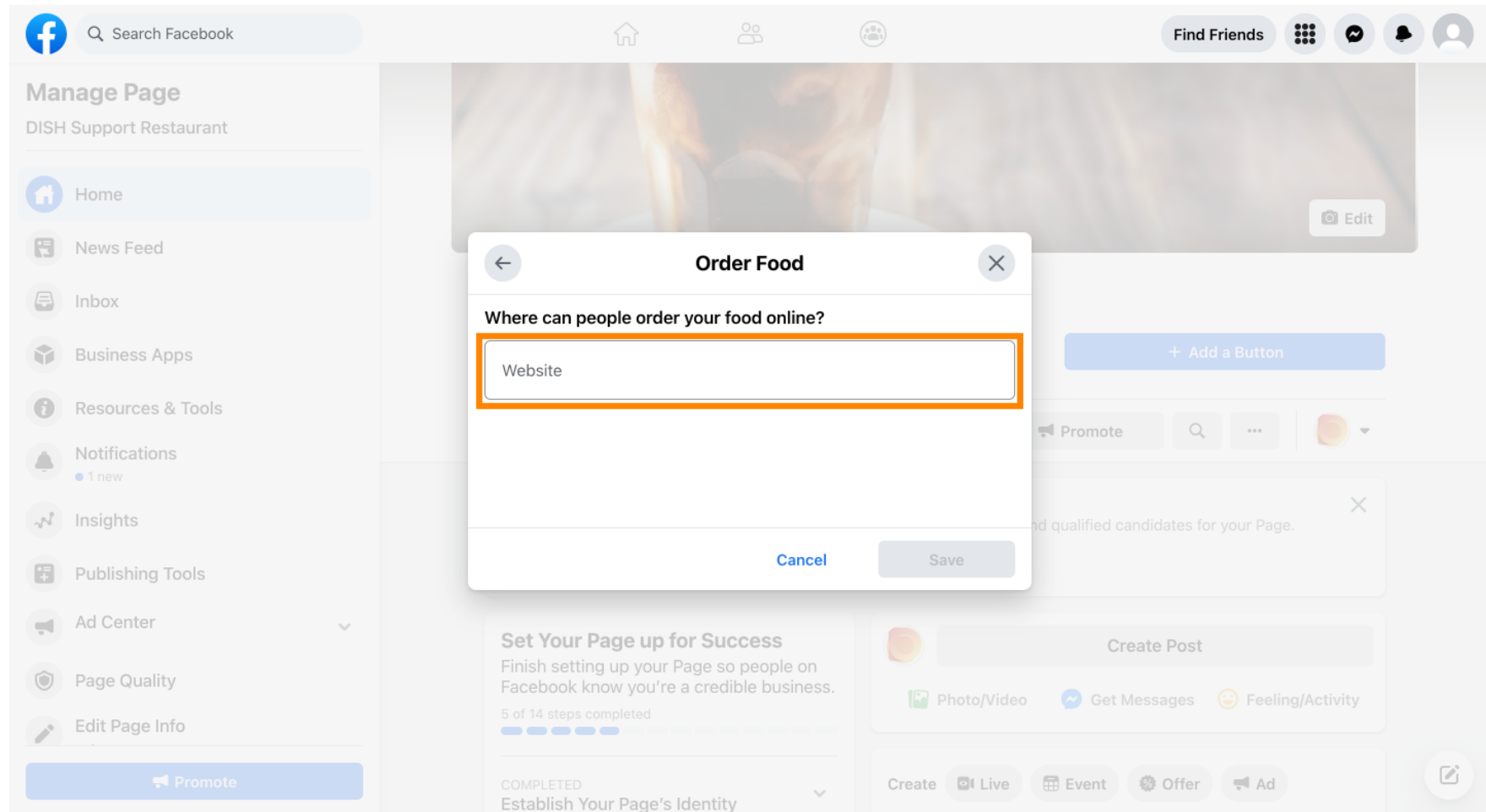



And click on **save** to proceed.

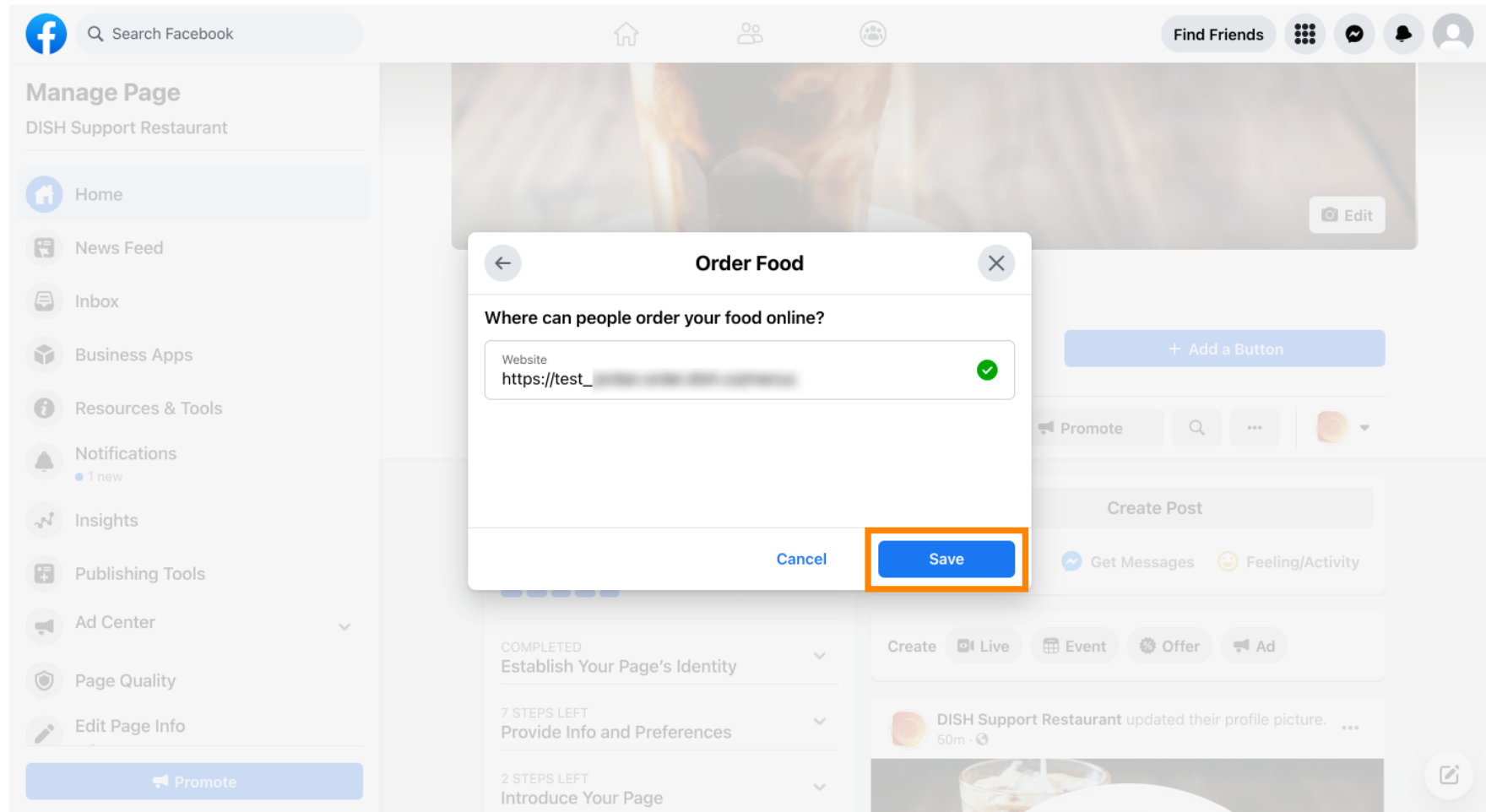



The small **pop-up** in the bottom left corner indicates that the button was successfully added.

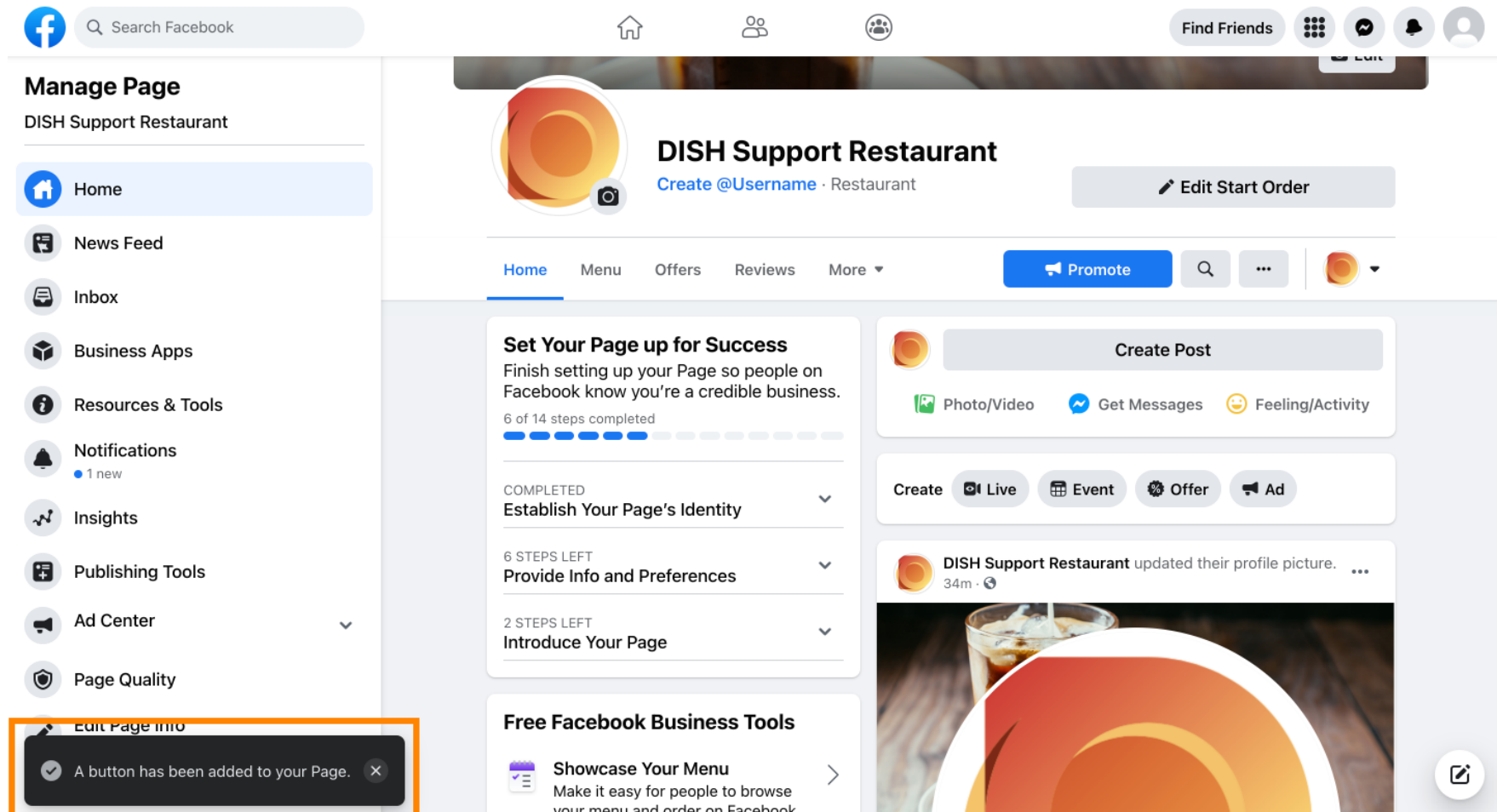

The screenshot displays the Facebook interface for the 'DISH Support Restaurant' page. On the left, the 'Manage Page' sidebar is visible, with 'Edit Page Info' highlighted. A dark grey pop-up notification is present in the bottom left corner, containing a checkmark icon and the text: 'A button has been added to your Page.' The main content area shows the restaurant's profile, including the name 'DISH Support Restaurant', a 'Create Post' button, and a progress bar for 'Set Your Page up for Success' with 6 of 14 steps completed. Below this, there are sections for 'Establish Your Page's Identity', 'Provide Info and Preferences', and 'Introduce Your Page'. A 'Free Facebook Business Tools' section is also visible, featuring a 'Showcase Your Menu' option.



This is how it will look like for your guests.

