

- Prvi korak je otvoriti mobilnu aplikaciju DISH i prijaviti se. Kliknite na **prijavu** za dalje.

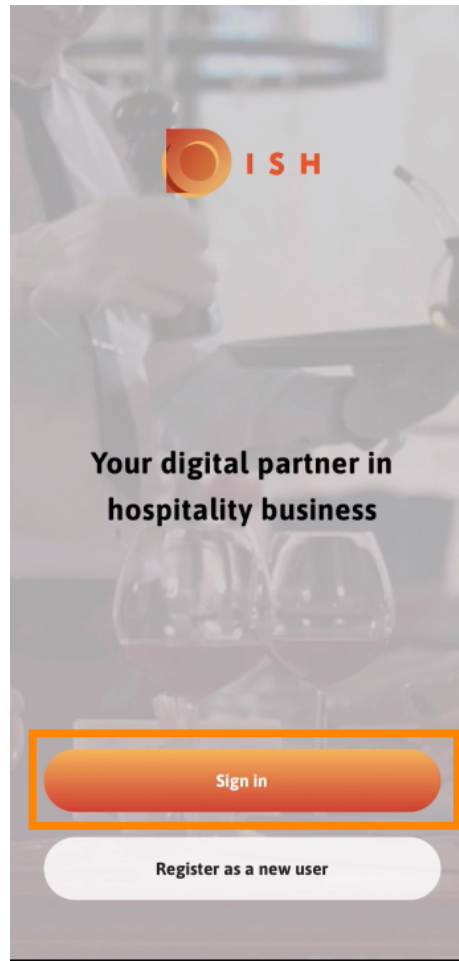

-  Kliknite na **nastavak** da biste bili preusmjereni na stranicu s jedinstvenim znakom DISH.

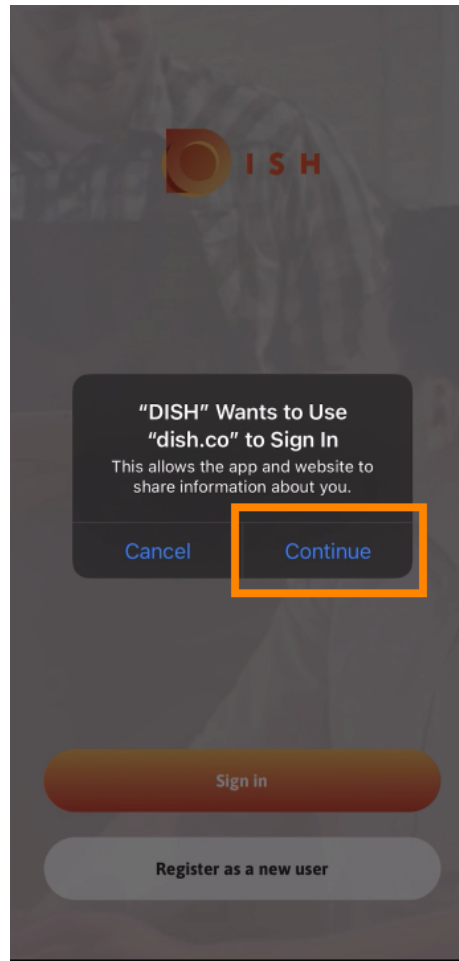



Unesite **korisničko ime** i **lozinku** .

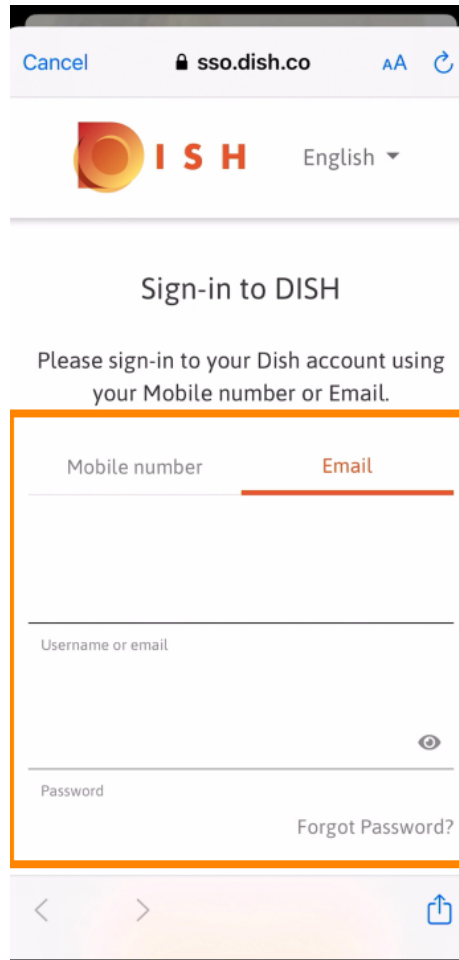

The screenshot shows the mobile sign-in page for DISH. At the top, there is a browser address bar with "Cancel", a lock icon, "sso.dish.co", and "AA" and refresh icons. Below the address bar is the DISH logo and a language dropdown menu set to "English". The main heading is "Sign-in to DISH". Below this, a message reads: "Please sign-in to your Dish account using your Mobile number or Email." There are two tabs: "Mobile number" and "Email", with "Email" being the active tab. Below the tabs is a text input field labeled "Username or email". Below that is a password input field labeled "Password" with a toggle icon (an eye) to its right. At the bottom right of the password field is a link that says "Forgot Password?". The bottom of the screen shows standard mobile navigation icons: back, forward, and share.



Dovršite ovaj korak klikom na **prijavu**.

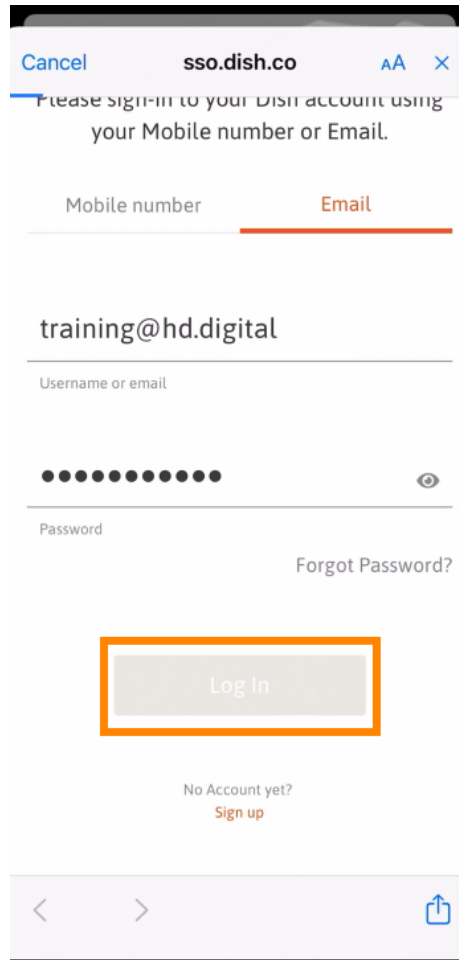

Cancel sso.dish.co AA X

Please sign-in to your Dish account using your Mobile number or Email.

Mobile number Email

training@hd.digital

Username or email

●●●●●●●●●●

Password

Forgot Password?

Log In

No Account yet?
Sign up



Alat za **rezervaciju jela** bit će prikazan ispod vaših alata. Kliknite na nju da otvorite svoju nadzornu ploču.

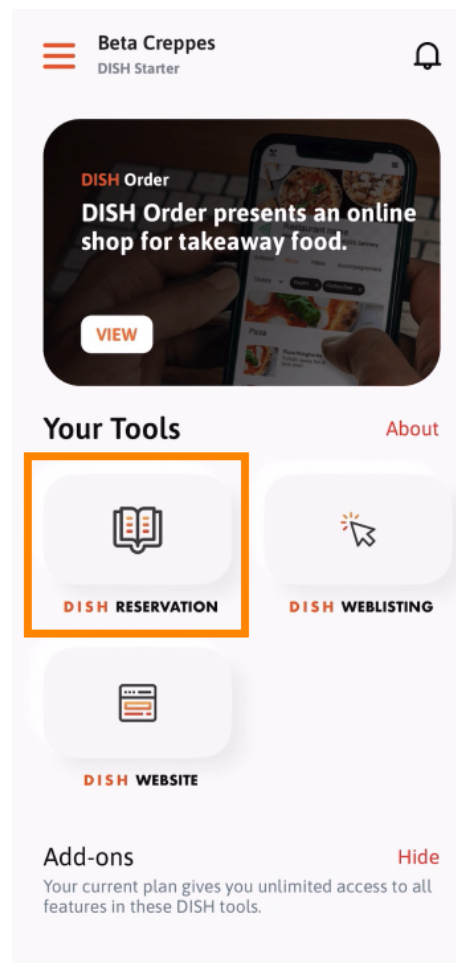



Nastavite klikom na **Rezervacija DISH**.

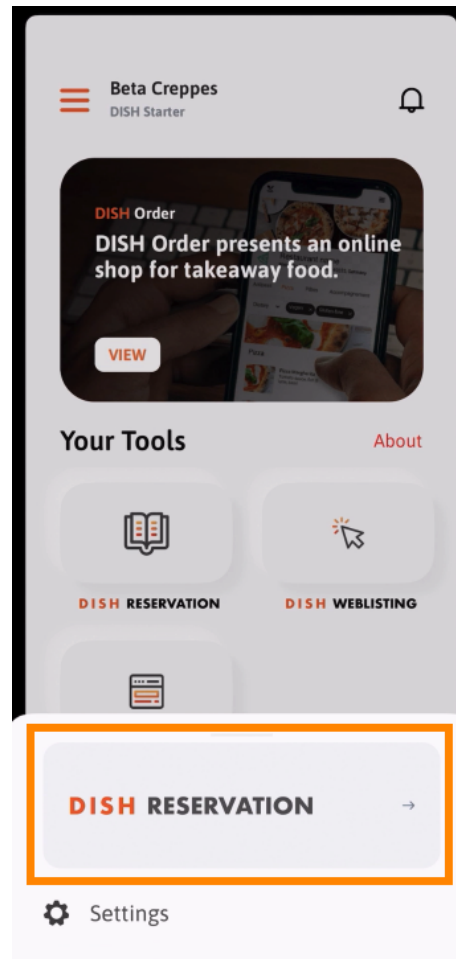



Kako biste osigurali visoke standarde kvalitete, pristanite na **korištenje kolačića** .

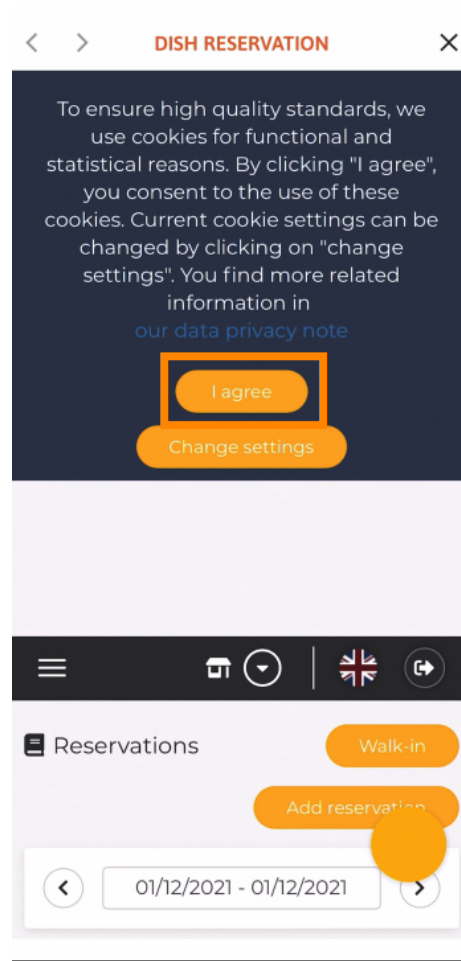

 To je to. Sada ste na mobilnoj verziji DISH Reservation.

