

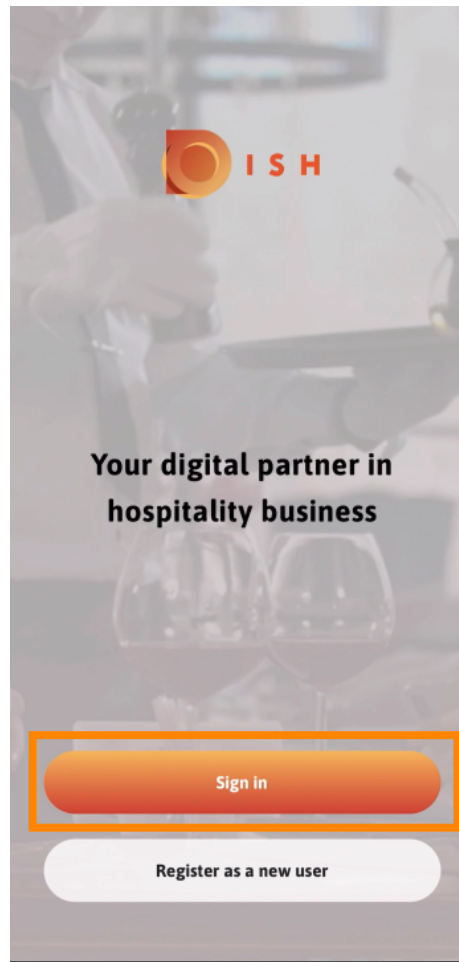

Az első lépés a DISH mobilalkalmazás megnyitása és bejelentkezés. Kattintson a **Bejelentkezés** gombra a továbblépéshez.

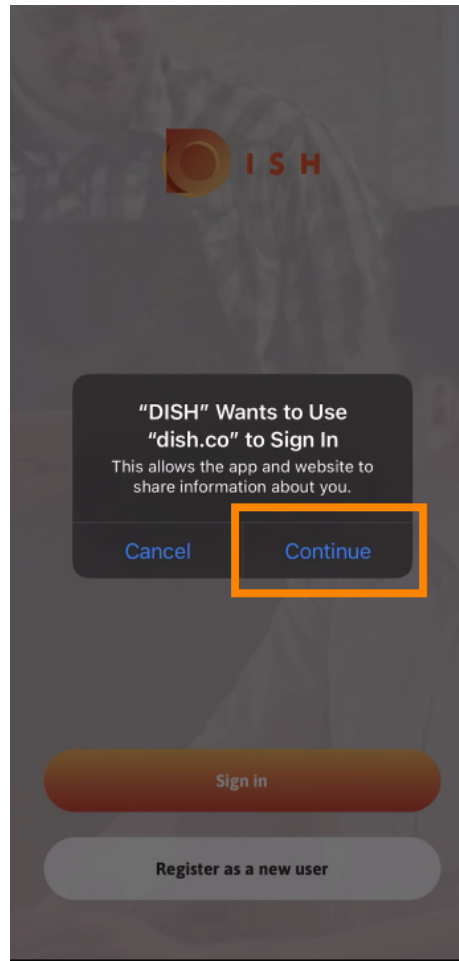

-  Kattintson a **tovább** gombra , hogy átirányítsa a DISH szimplajelre az oldalon.





Adja meg a **felhasználónevet** és a **jelszót** .

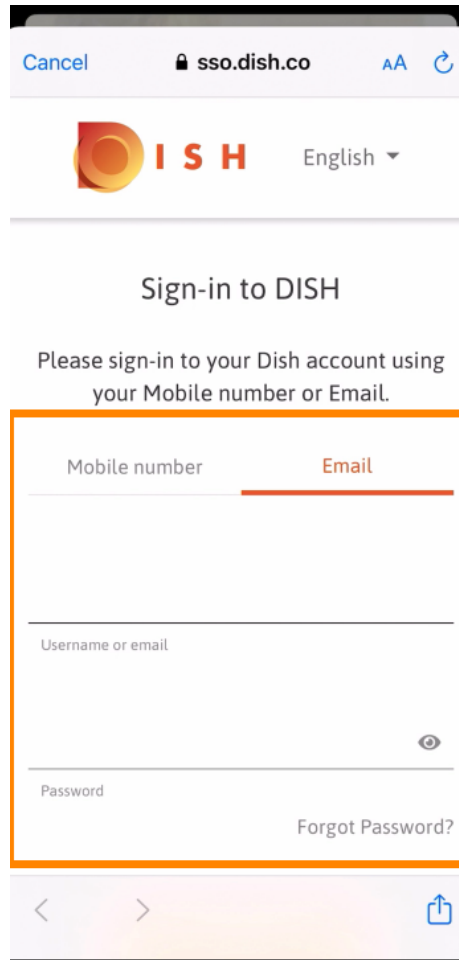

The screenshot shows the mobile app interface for signing in to a Dish account. At the top, there is a browser address bar with "Cancel", a lock icon, "sso.dish.co", and "AA" and refresh icons. Below this is the Dish logo and a language selector set to "English". The main heading is "Sign-in to DISH". Below the heading, it says "Please sign-in to your Dish account using your Mobile number or Email." There are two tabs: "Mobile number" and "Email", with "Email" being the active tab. Below the tabs is a large text input field labeled "Username or email". Below that is a password input field labeled "Password" with a toggle eye icon. A "Forgot Password?" link is located to the right of the password field. The bottom of the screen shows navigation arrows and a share icon.

 Hajtsa végre ezt a lépést a **Bejelentkezés** gombra kattintva .

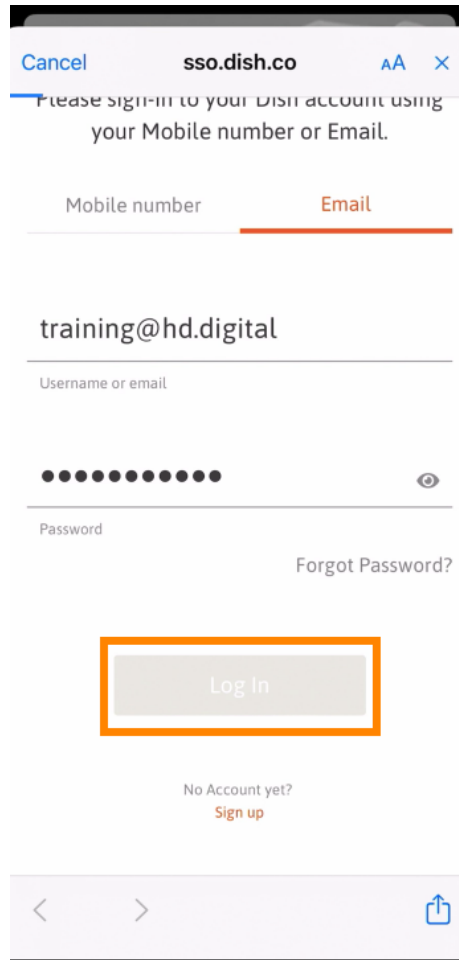

Cancel sso.dish.co AA X

Please sign-in to your Dish account using your Mobile number or Email.

Mobile number Email

training@hd.digital

Username or email

●●●●●●●●●● 

Password

Forgot Password?

Log In

No Account yet?  
[Sign up](#)

 A **DISH Reservation eszköz** megjelenik az eszközök alatt. Kattintson rá az irányítópult megnyitásához.

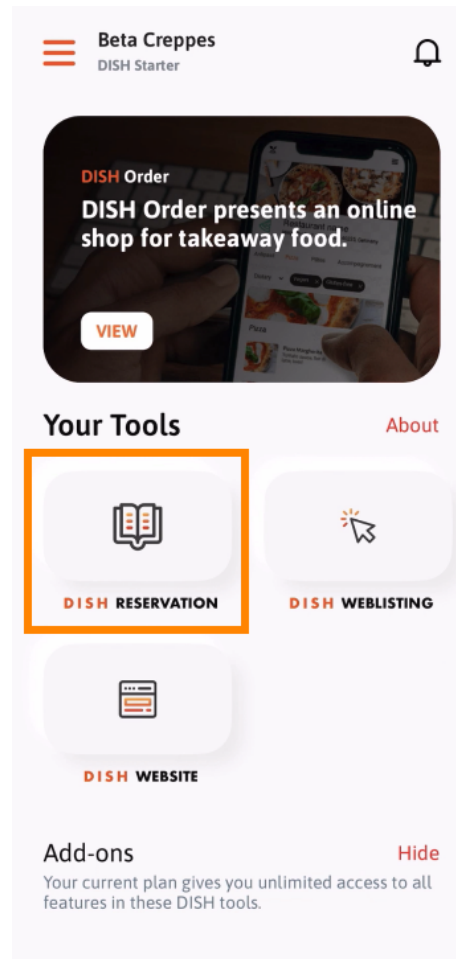

 Folytassa az **ÉTEL foglalás** lehetőségre kattintva .

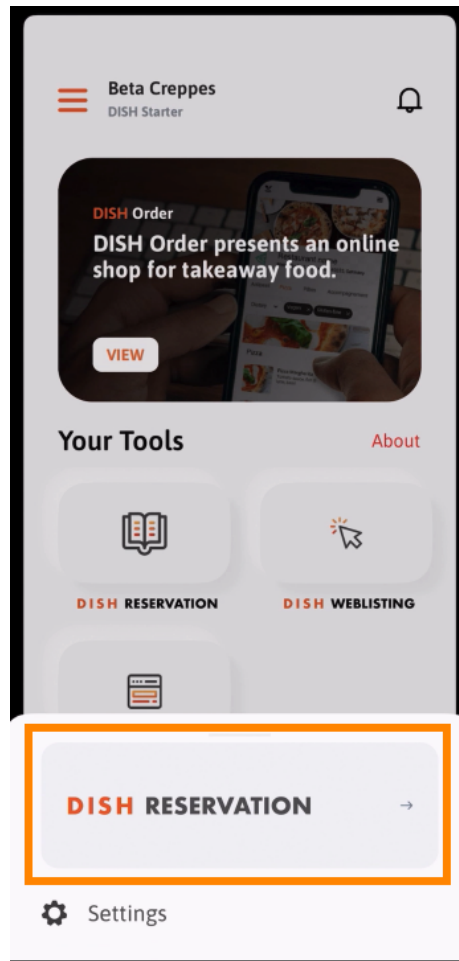



A magas minőségi szabványok biztosítása érdekében fogadja el a **cookie-k használatát** .

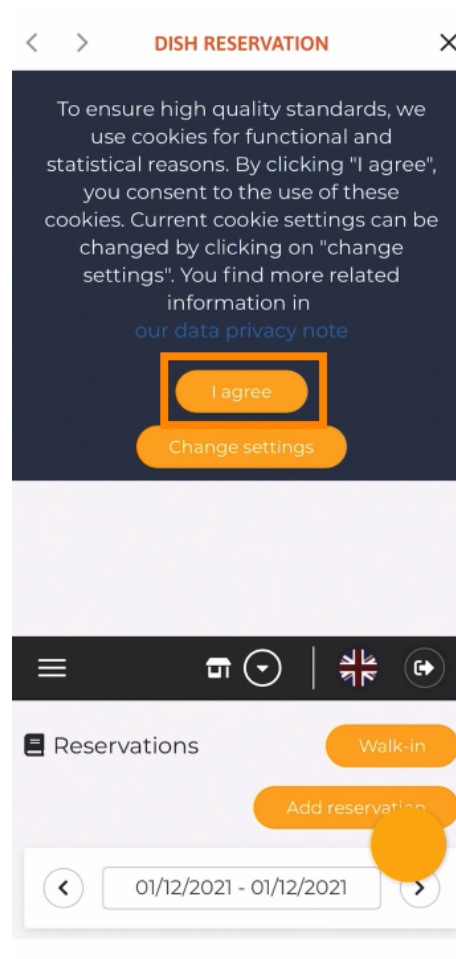



Ez az. Ön most a DISH Reservation mobil verziójában van.

