

-  Prvým krokom je otvorenie mobilnej aplikácie DISH a prihlásenie. Kliknutím na **prihlásenie** sa dostanete ďalej.

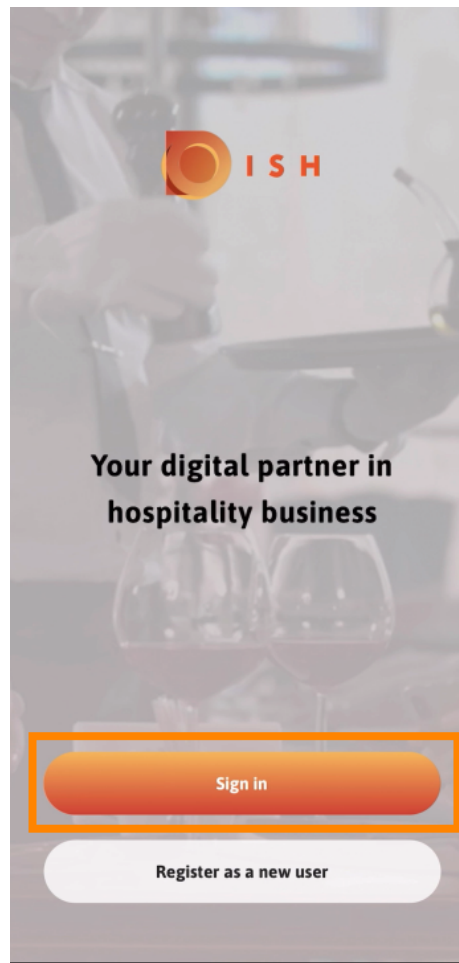

-  Kliknite na **pokračovať**, aby ste boli presmerovaní na stránku jednotného prihlásenia DISH.

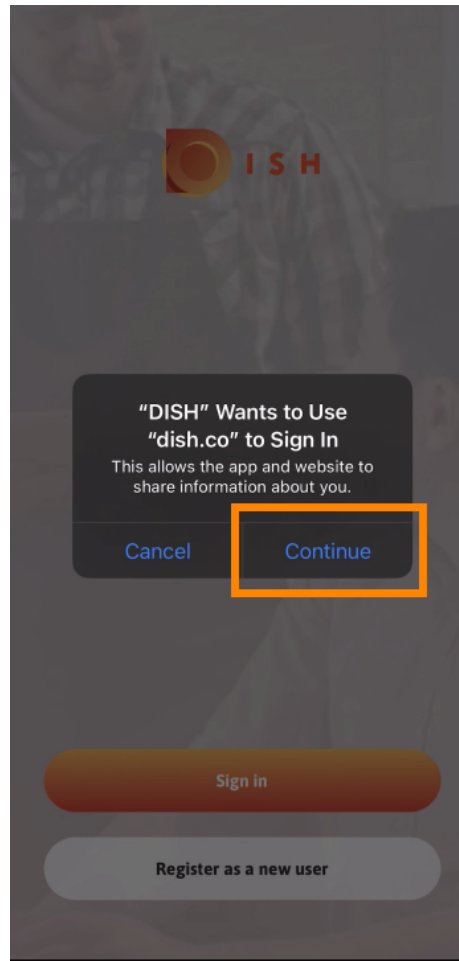

 Zadajte **používateľské meno** a **heslo** .

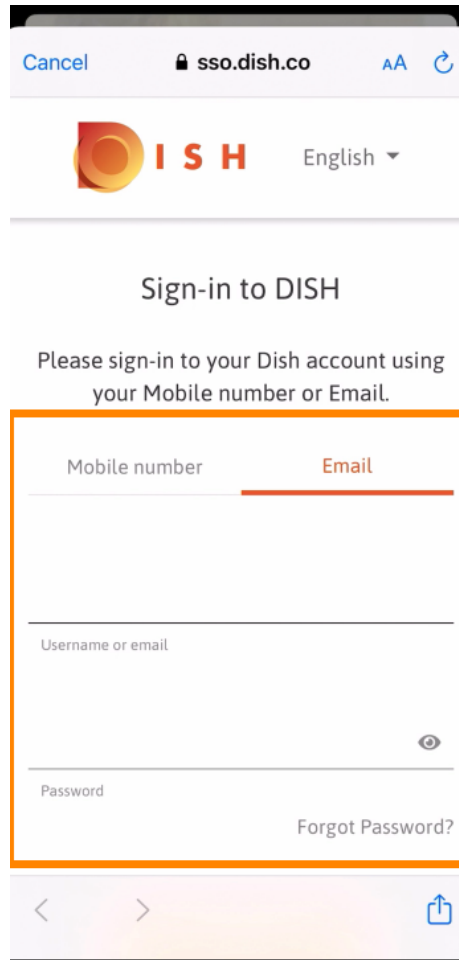

The screenshot shows a mobile browser interface for the DISH login page. At the top, there is a navigation bar with a 'Cancel' button, the URL 'sso.dish.co', and icons for font size and refresh. Below this is the DISH logo and a language selector set to 'English'. The main heading is 'Sign-in to DISH', followed by the instruction: 'Please sign-in to your Dish account using your Mobile number or Email.' There are two tabs: 'Mobile number' and 'Email', with 'Email' being the active tab. Below the tabs is a large text input field labeled 'Username or email'. Underneath is a password input field labeled 'Password' with a toggle icon for visibility. A 'Forgot Password?' link is located to the right of the password field. The bottom of the screen shows standard mobile navigation icons: back, forward, and share.



Dokončíte tento krok kliknutím na **prihlásiť sa** .

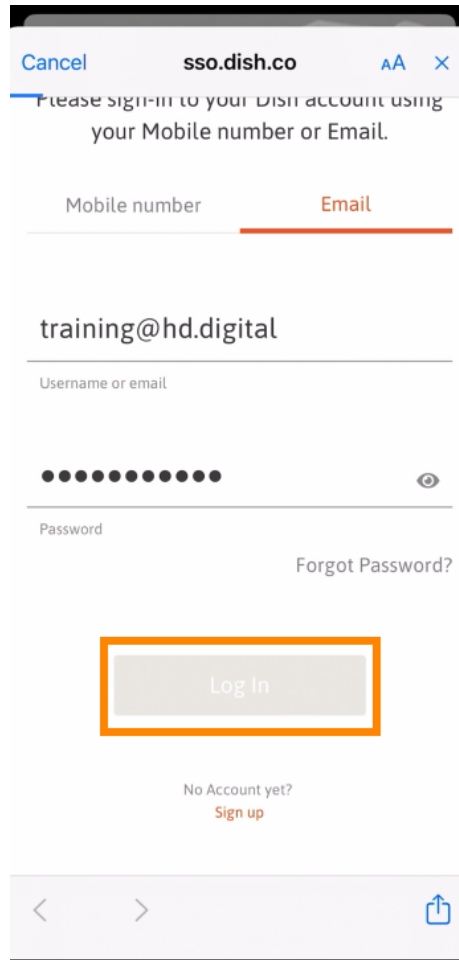

The screenshot shows the login page for sso.dish.co on a mobile device. The page has a white background with a grey header bar containing 'Cancel', 'sso.dish.co', 'AA', and a close icon. Below the header, there is a blue arrow pointing to the text 'Please sign-in to your Dish account using your Mobile number or Email.' There are two tabs: 'Mobile number' and 'Email', with 'Email' being the active tab. Below the tabs is a text input field containing 'training@hd.digital' with the label 'Username or email' below it. Underneath is a password input field with a series of dots and an eye icon, with the label 'Password' below it. To the right of the password field is a link 'Forgot Password?'. At the bottom of the form is a large grey button with the text 'Log In' highlighted by an orange border. Below the button is the text 'No Account yet?' and a link 'Sign up'. At the very bottom of the screen is a navigation bar with back, forward, and share icons.

Nástroj **Rezervácia DISH** sa zobrazí pod vašimi nástrojmi. Kliknutím naň otvoríte informačný panel.

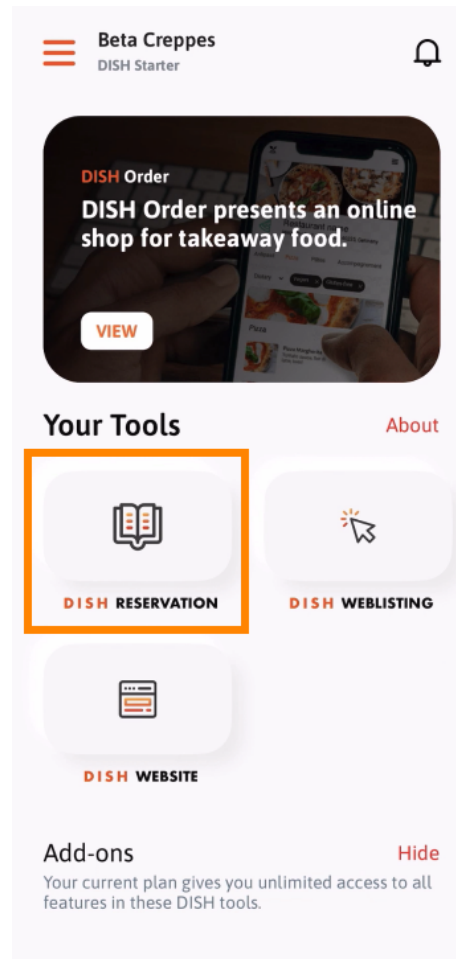



Pokračujte kliknutím na **Rezerváciu DISH**.

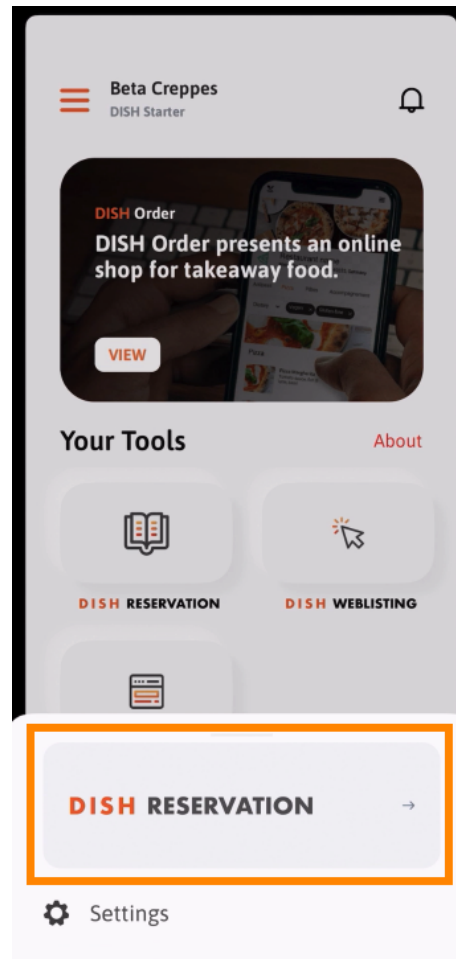



Na zabezpečenie vysokých štandardov kvality súhlaste s **používaním súborov cookie** .

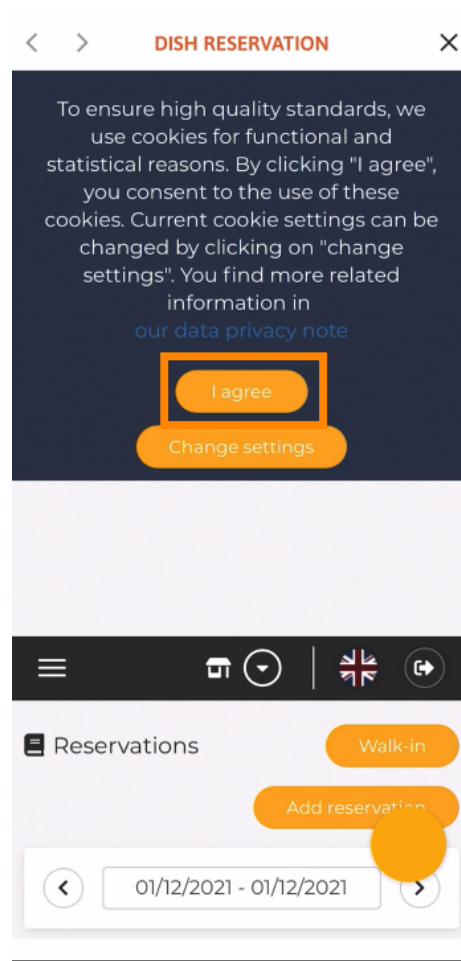

 To je všetko. Teraz ste v mobilnej verzii rezervácie DISH.

