

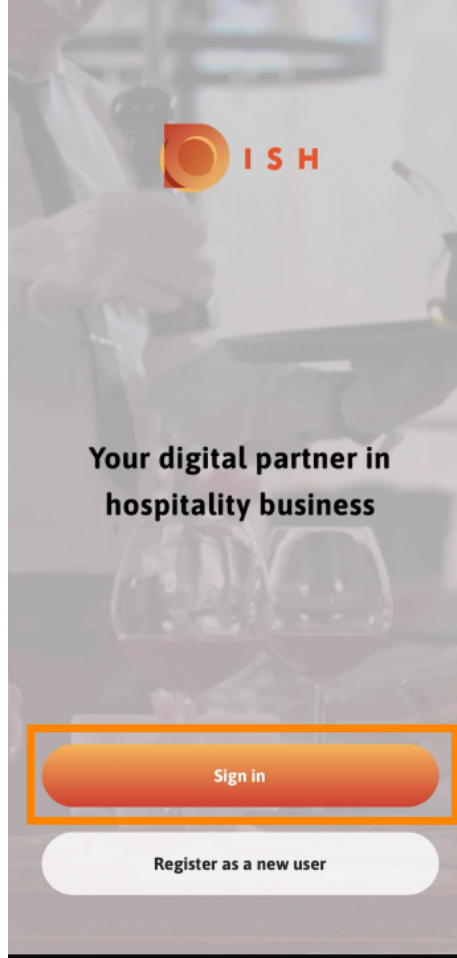



İlk adım, DISH mobil uygulamasını açmak ve giriş yapmaktır. Daha ileri gitmek için **oturum aç'a** tıklayın .



 DISH tek oturum açma sayfasına yönlendirilmek için **devam** et'e tıklayın .

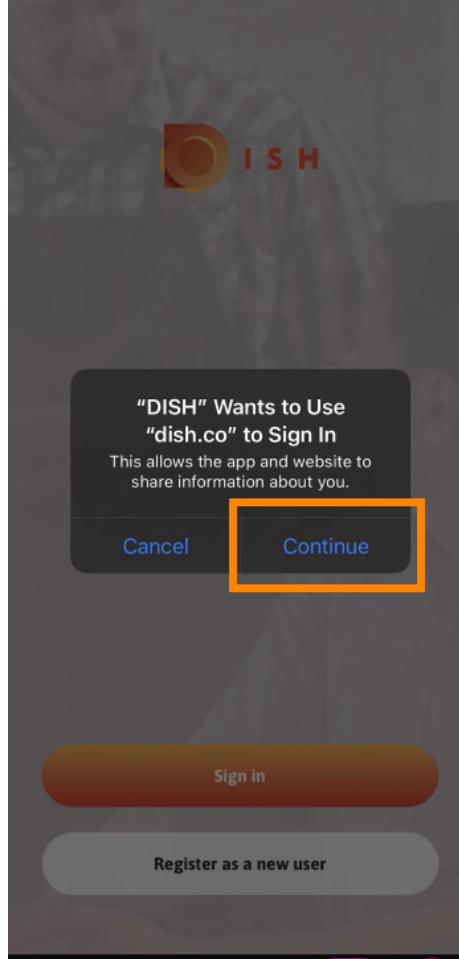



Kullanıcı adını ve şifreyi girin .

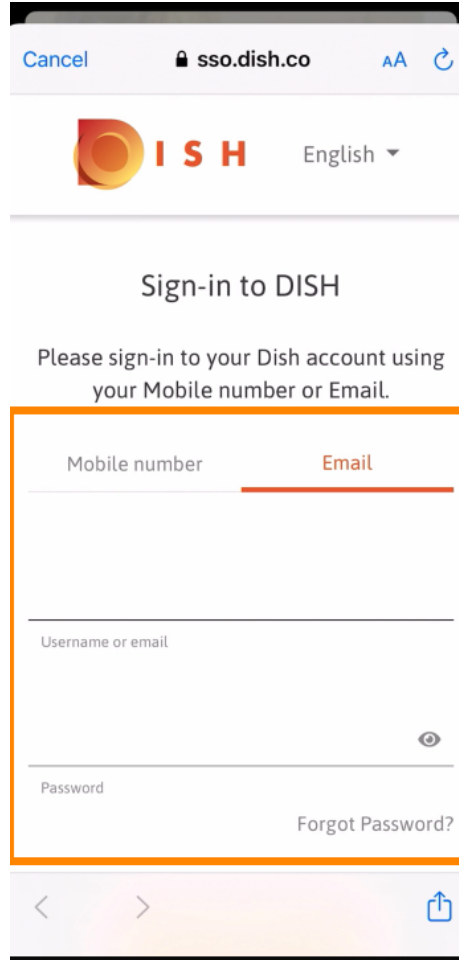

The screenshot shows the mobile app interface for signing in to a DISH account. The browser address bar at the top displays "sso.dish.co". Below the browser bar is the DISH logo and a language selector set to "English". The main heading is "Sign-in to DISH", followed by the instruction: "Please sign-in to your Dish account using your Mobile number or Email." There are two tabs: "Mobile number" and "Email", with "Email" currently selected. Below the tabs is a text input field labeled "Username or email". Underneath that is a password input field labeled "Password" with a toggle icon for visibility. A "Forgot Password?" link is located to the right of the password field. The entire sign-in form area is highlighted with an orange border.

 Giriş yap seçeneğine tıklayarak bu adımı tamamlayın .

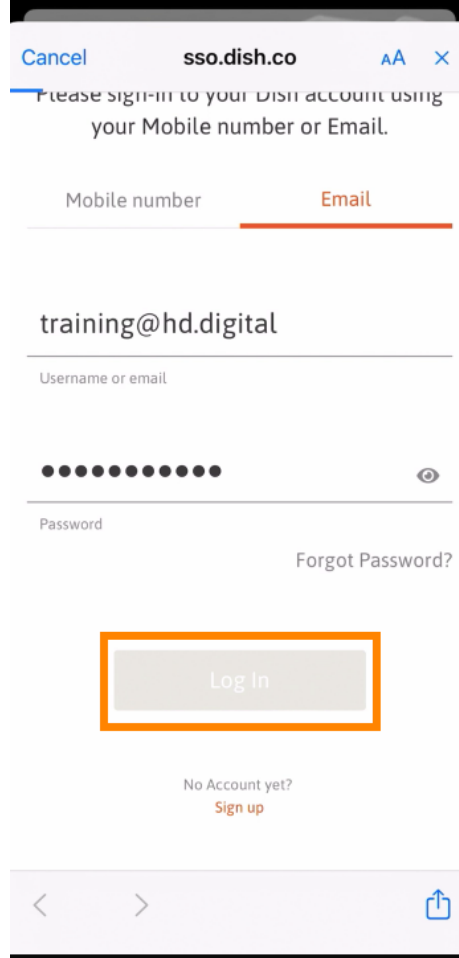

Cancel sso.dish.co AA X

Please sign-in to your Dish account using your Mobile number or Email.

Mobile number Email

training@hd.digital

Username or email

.....

Password

Forgot Password?

Log In

No Account yet?
Sign up



DISH Rezervasyon aracı , araçlarınızın altında görüntülenecektir. Kontrol panelinizi açmak için üzerine tıklayın.

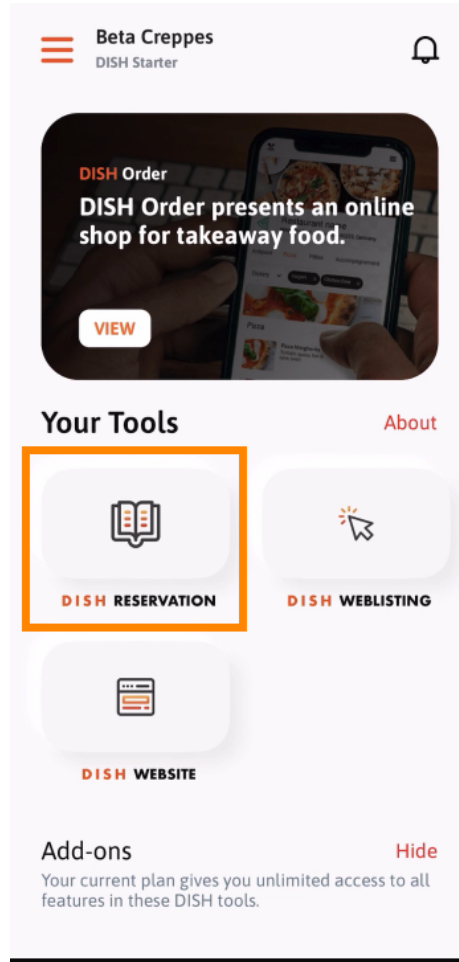

 DISH Rezervasyonu'na tıklayarak devam edin .

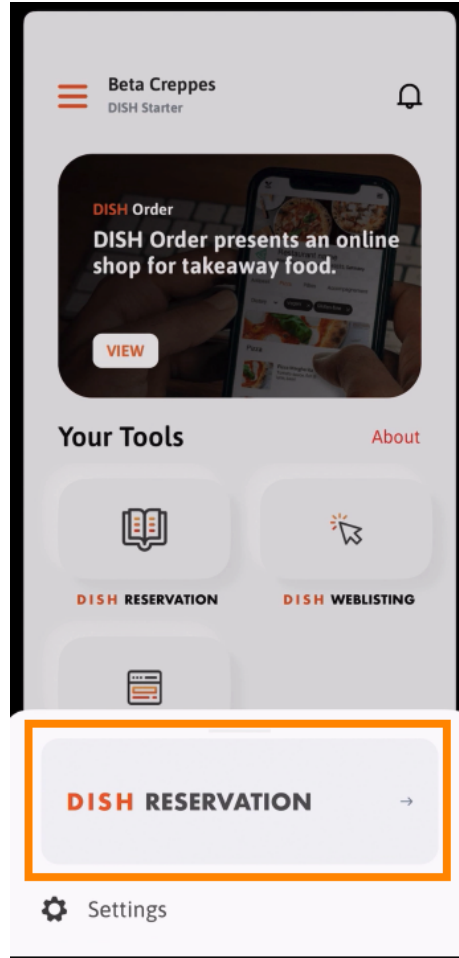



Yüksek kalite standartlarını sağlamak için **çerezlerin kullanımını** kabul edin .

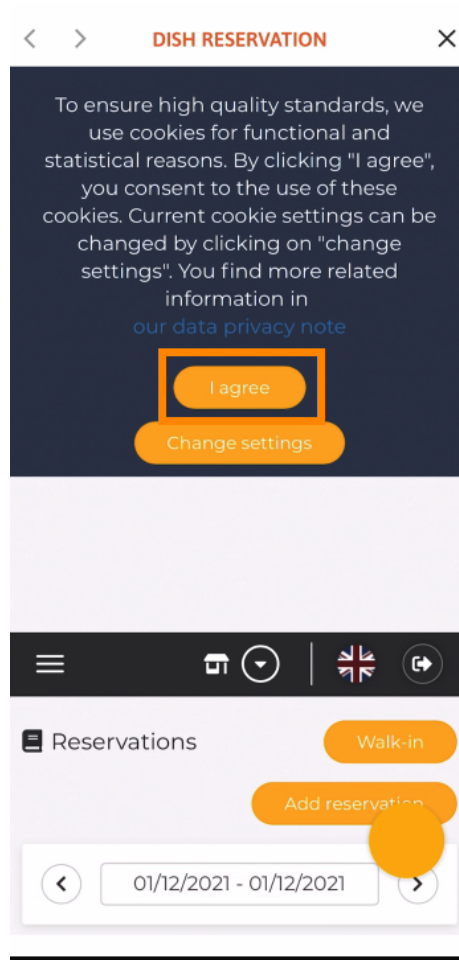

 Bu kadar. Artık DISH Rezervasyon'un mobil versiyonundasınız.

